

OPT7 **GLOW**

OPT7 GLOW APPLICATION USER GUIDE

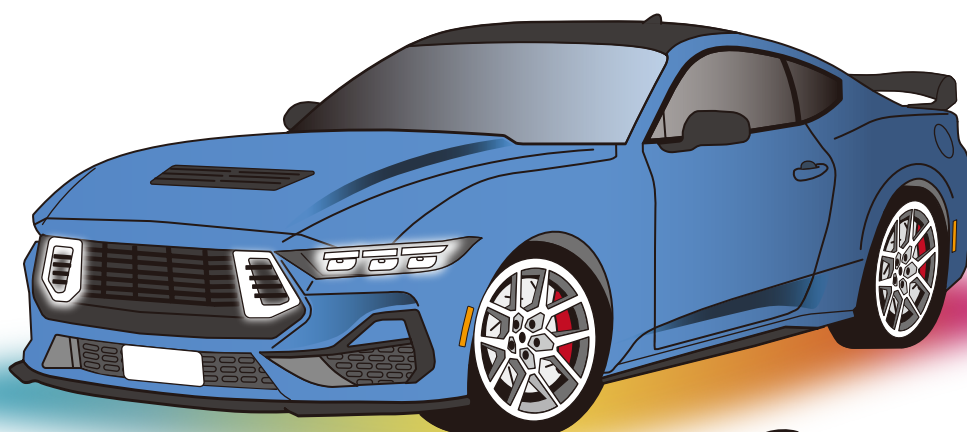

QR CODE TO DOWNLOAD

GET IT ON
Google Play

Download on the
App Store



SCAN FOR APP

OPT7[®]
GLOW



Download the free "OPT7 GLOW" App

- App iOS (12+) available on App Store
- Android (8+) available on Google Play

CONTENTS

How To Connect & Disconnect	2
System Settings	4
Device Settings	5
RGB Mode	6
Rhythm Mode	7
Light Mode	9
Pixel Setting	10
Color Setting	12

NOTICE

OPT7 GLOW supports the car media system with Bluetooth and Android Auto, but does not support Apple Carplay.

HOW TO CONNECT

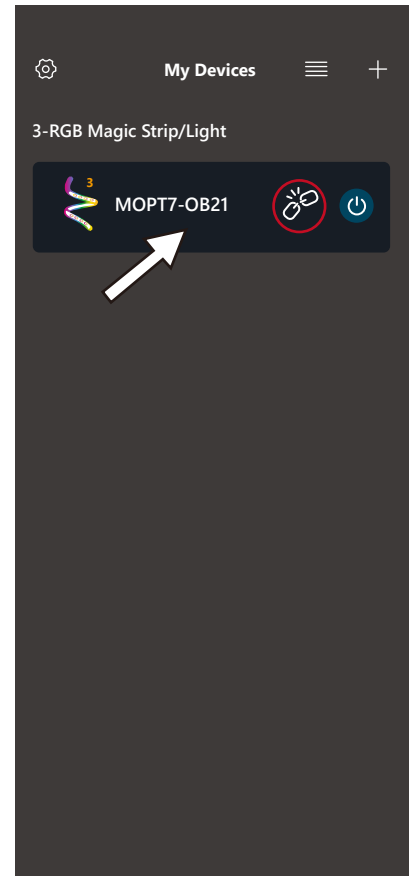
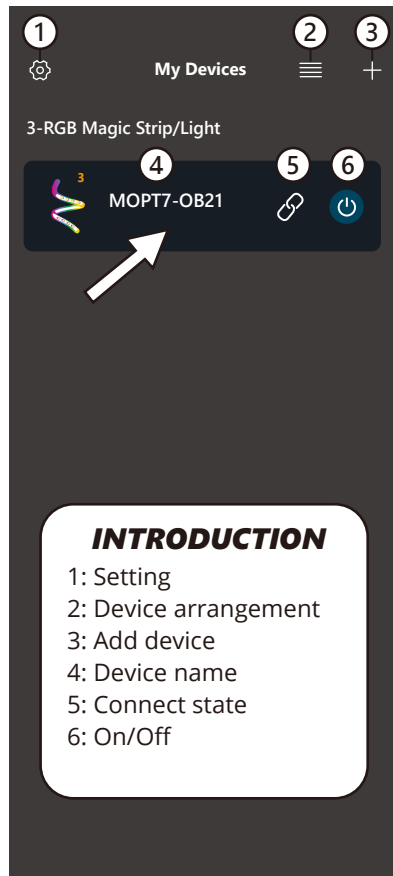
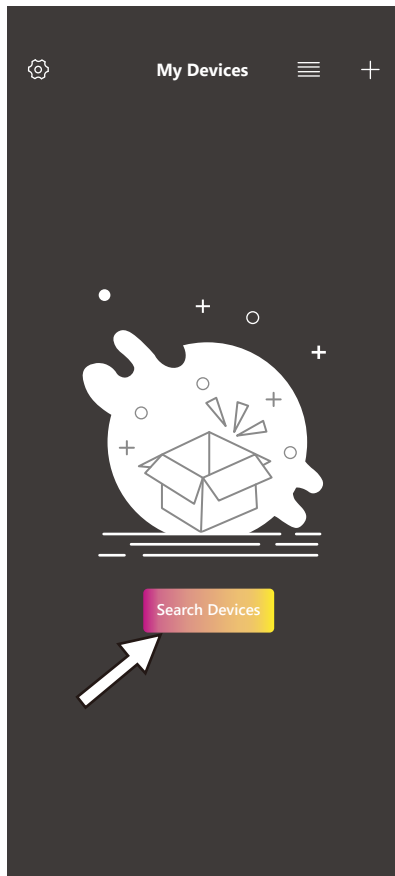

STEP 1

First view the OPT7 GLOW. After installing the OPT7 light Kits, open the OPT7 GLOW and keep the Bluetooth open then click "Search Devices" to connect.

STEP 2

OPT7 GLOW will detect OPT7 light Kits automatically. Click the device into the light control mode.

NOTICE

If the OPT7 GLOW shows the icon , which means the device is not connected. Please click this icon again or check if the Bluetooth and the OPT7 light kits work normally.

IMPORTANT

- *On the Android system, it needs to allow the Nearby Devices Permission to search the devices.
- *OPT7 GLOW connects a maximum of 4 devices.
- *If there is no device on the list, please check the Auto Add Devices.
(See more system settings on the page 3.)

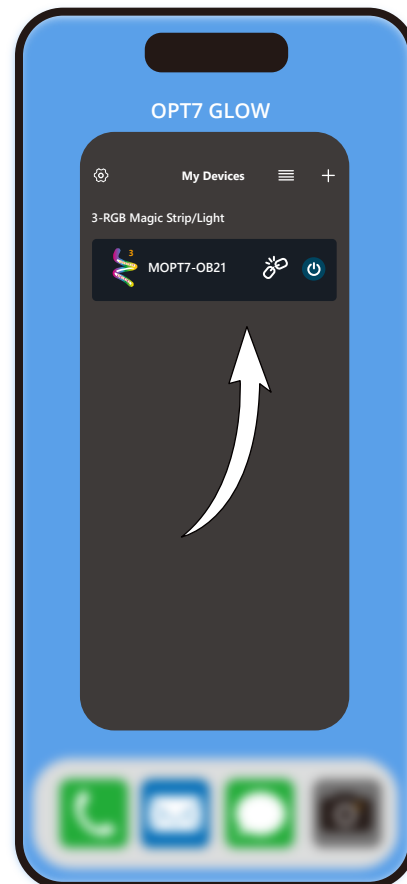
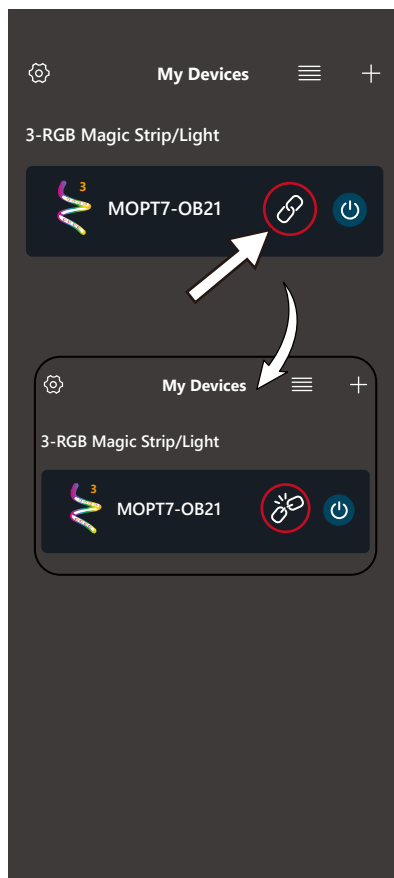
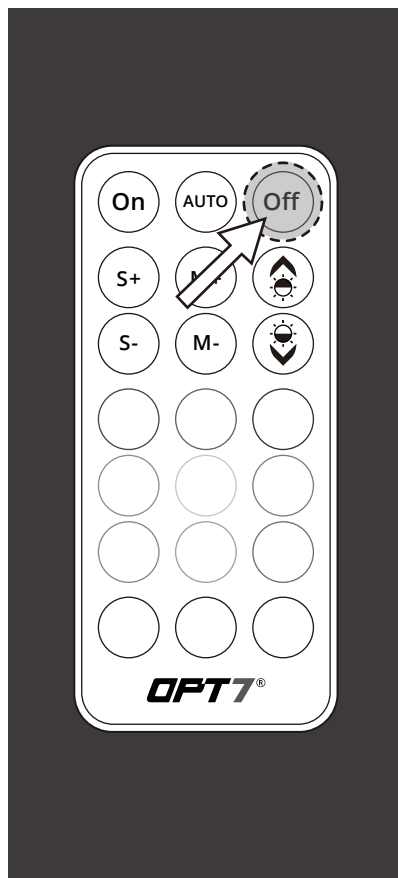

HOW TO DISCONNECT



STEP 1

Use the remote control to disconnect the OPT7 light kits.
*need to align the control box

STEP 2

To disconnect the OPT7 light kits. Click the icon  to .

STEP3

Ensure the OPT7 light kits are turned off using the remote control. Then, disconnect the OPT7 GLOW and slide the App out to power it off.

IMPORTANT

*Turning off the OPT7 GLOW completely helps avoid excessive battery consumption and extends the lifespan of the OPT7 light kits.

SYSTEM SETTINGS

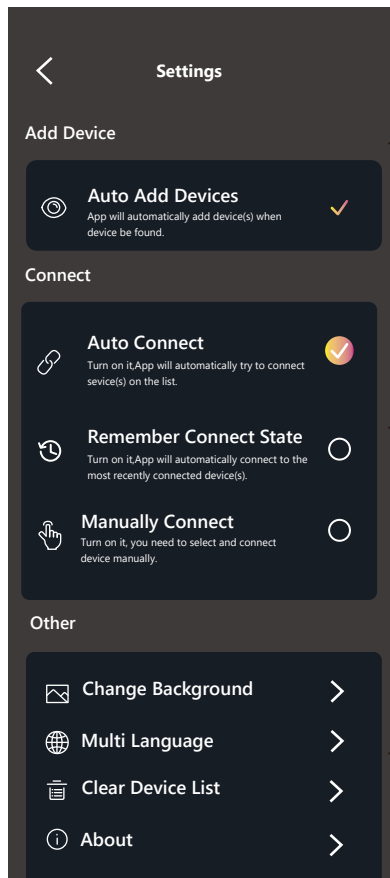
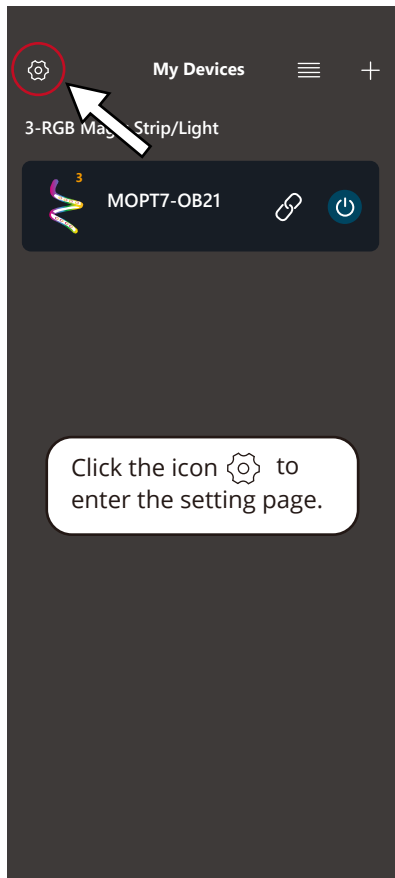

INTRODUCTION 1

OPT7 GLOW will detect the OPT7 light kits automatically.
*Recommended to enable the function

INTRODUCTION 2

Auto Add Devices:

OPT7 GLOW will connect all devices on the list.

Remember Connect State

OPT7 GLOW will remember the last connected device(s) and light mode.

Manually Connect

OPT7 GLOW will not connect any devices until choosing one.

INTRODUCTION 3

Other settings:

Customized settings, including background, language, and clear device list.

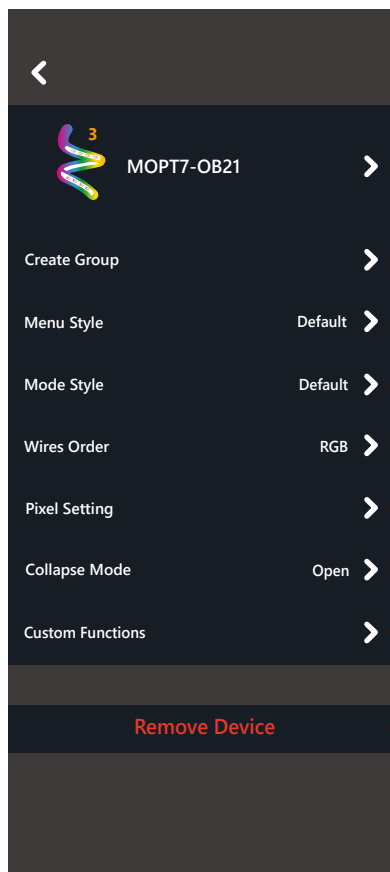
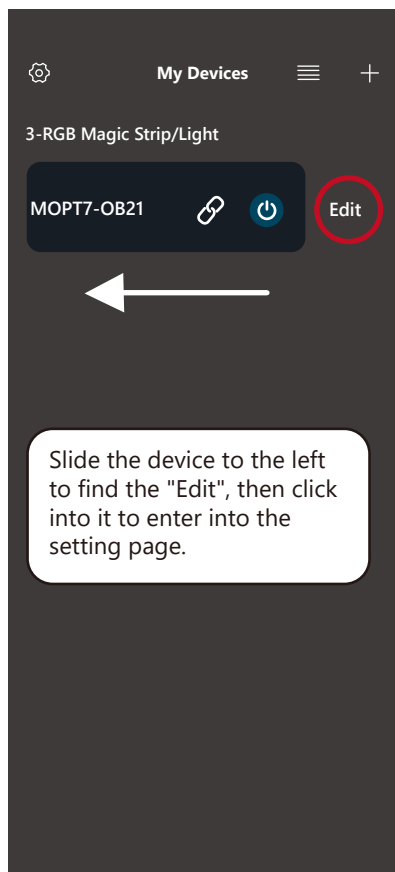

INTRODUCTION

1: Device setting
(Icon /name)

2: Group setting

3: Menu Style setting
(Default/Tab Bar/Beehive)

4: Light Mode Style
(Default/GIF/Text)

5: Wire Setting
(Adjust RGB order)

6: Pixel Setting
(Not support)

7: Collapse Mode
(Not support)

8: Custom Functions
(Not support)

9: Remove Device
(Clear and forget the device)

DEVICE RENAME

How To Rename the Devices and Create a Group

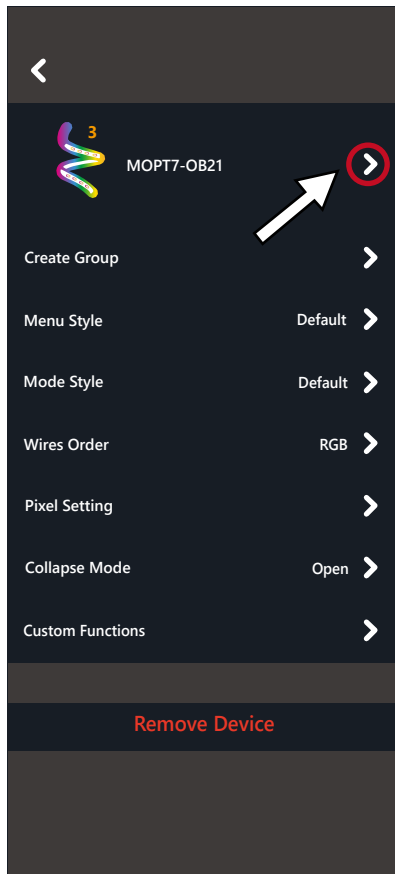

Click on the arrow to enter the device page.

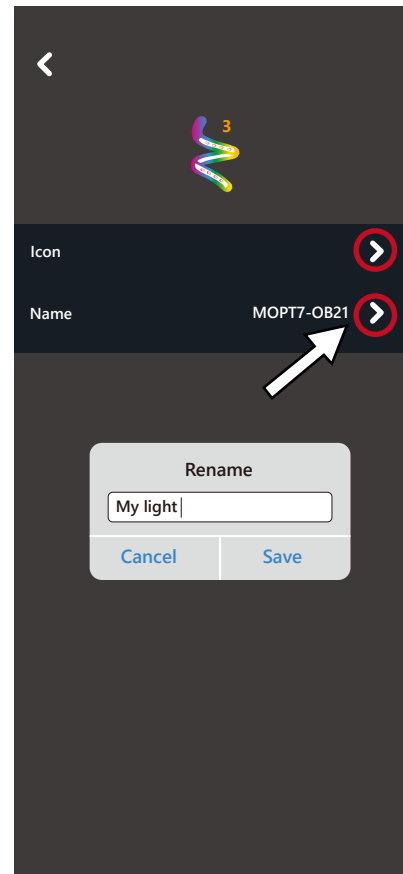

Click the arrow to open the pop-up menu, then rename the device.

DEVICE SETTING

How To Rename the Devices and Create a Group

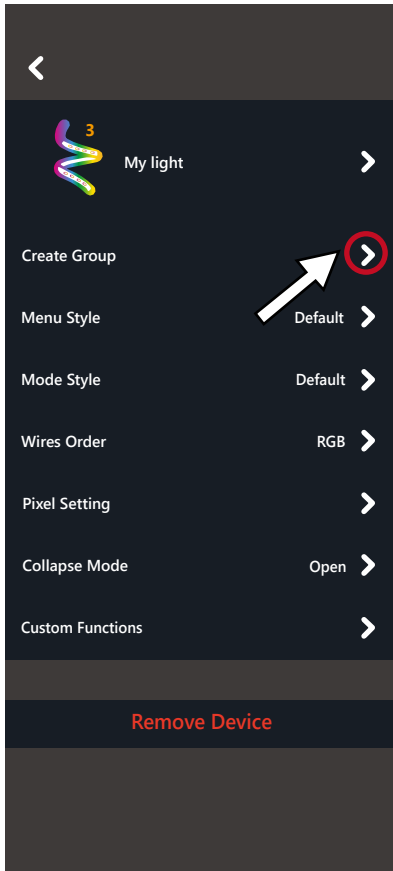

To create a group, click on the arrow to enter the group page.

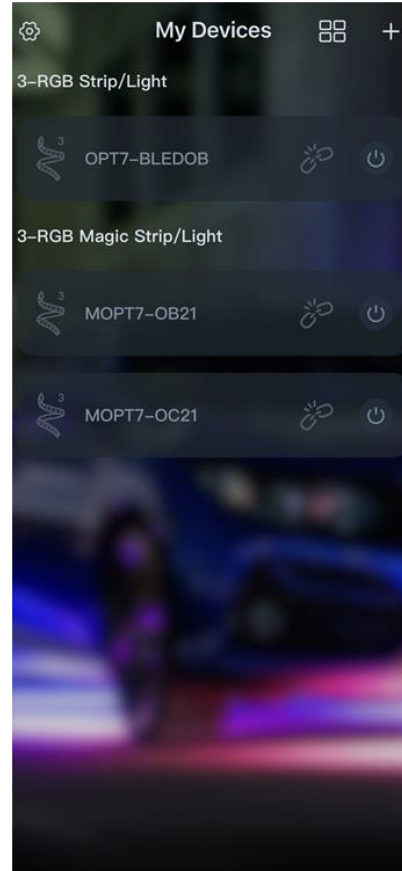

Grouping can only be the same LED type: RGB or RGB Magic (DreamColor) strips/lights. Different LED types cannot be grouped or controlled together at the same time. You can have both RGB and DreamColor kits in the OPT7 Glow app, but they must be controlled separately and cannot be grouped together.

DEVICE SETTING

How To Rename the Devices and Create a Group

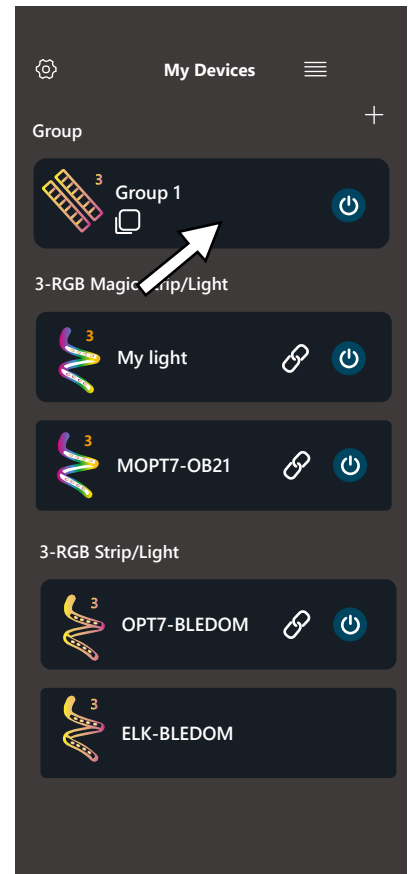
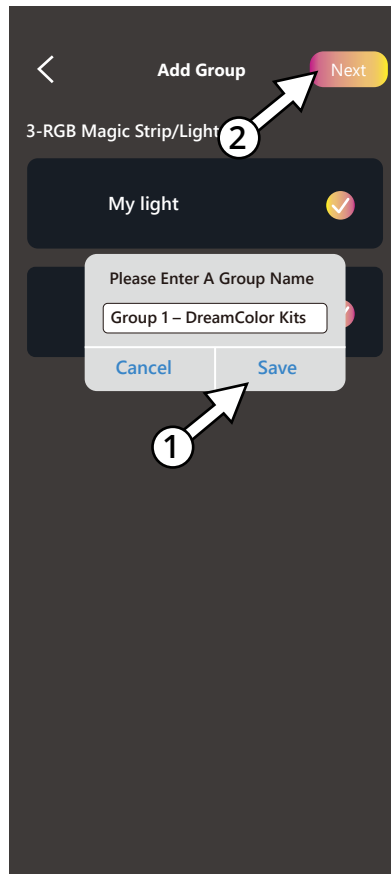
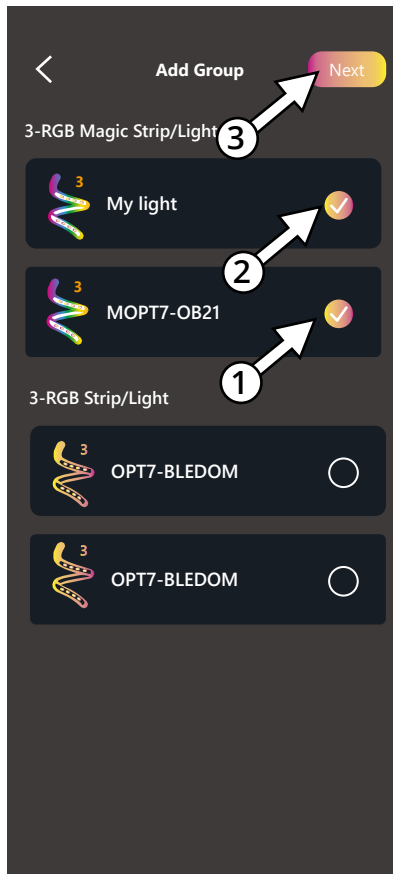

Select the same LED type as seen 1 & 2, then click next.

*ONLY THE SAME TYPE OF LED KIT CAN BE GROUP TOGETHER.
*MAX 4 ALLOWED TO ONE APP.

Enter the group name you want to use (for example, Magic Strip/Light for DreamColor ARGBIC kits). Once renamed, click SAVE to complete.

The app can now control the grouped LED kits together. Please note that some kits may have different color modes due to variations in strip length.

RGB MODE



USER INTERFACE

INTRODUCTION

- 1: Device name
- 2: Device setting
- 3: On/Off
- 4: RGB mode
- 5: Rhythm mode
- 6: Light mode
- 7: Scenes mode
- 8: More information

RGB MODE

INTRODUCTION

- 1: Touch to choose color
- 2: Shortcut color (6 color)
- 3: Favorite color (4 color) (click ⊕ then choose a color to create a shortcut; press the shortcut to delete)
- 4: Brightness adjust (0-100)

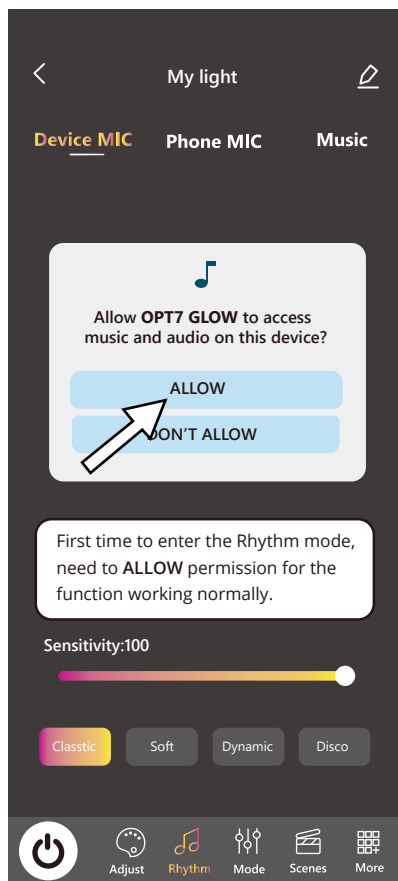
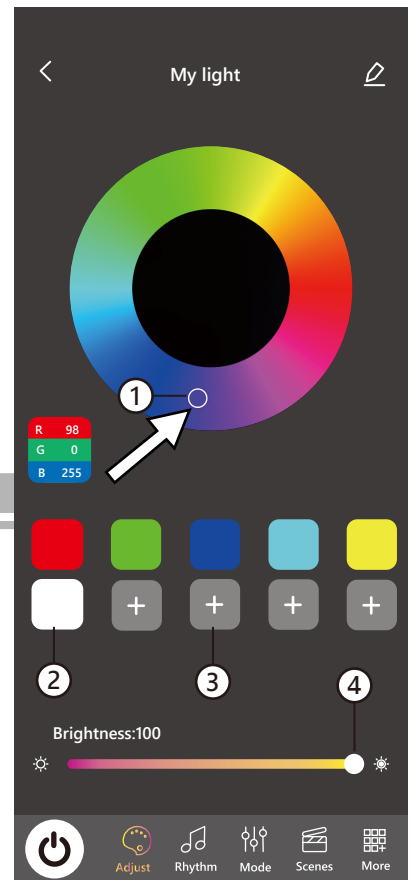

RHYTHM MODE-DEVICE MIC

INTRODUCTION

- 1: Cellphone MIC is receiving (Not all cellphone support)
- 2: Device name
- 3: Device setting
- 4: Device MIC (use the control box of the OPT7 light kits to receive)



- 5: Phone MIC (use the cellphone to receive)
- 6: Music MIC (use the cellphone music)
- 7: Sound wave (changes with the audio)
- 8: Record sensitivity adjust (0-100)
- 9: Light effect (4 modes)

*Not all OPT7 light Kits support the device MIC function.

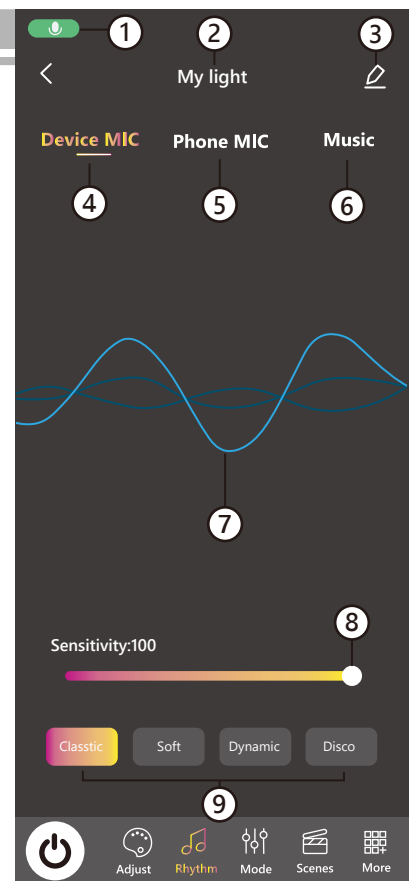

RHYTHM MODE

RHYTHM MODE-PHONE MIC

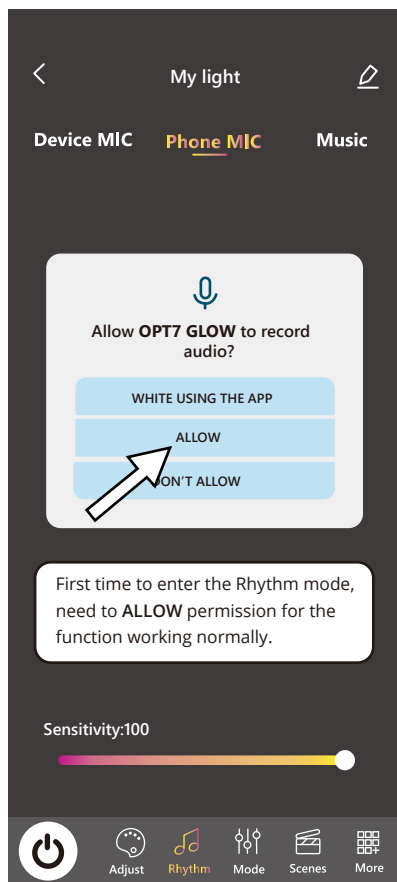

INTRODUCTION

- 1: Cellphone MIC is receiving (Not all cellphone support)
- 2: Device name
- 3: Device setting
- 4: Device MIC (use the OPT7 light to receive)
- 5: Phone MIC (use the cellphone to receive)
- 6: Music MIC (use the cellphone music)
- 7: Sound wave (changes with the audio)
- 8: Radio sensitivity adjust

IMPORTANT

*The Phone MIC supports Android Auto only

*When using the Phone MIC, users must enable the background permissions.

*Phone MIC supports only a device or a group at once.

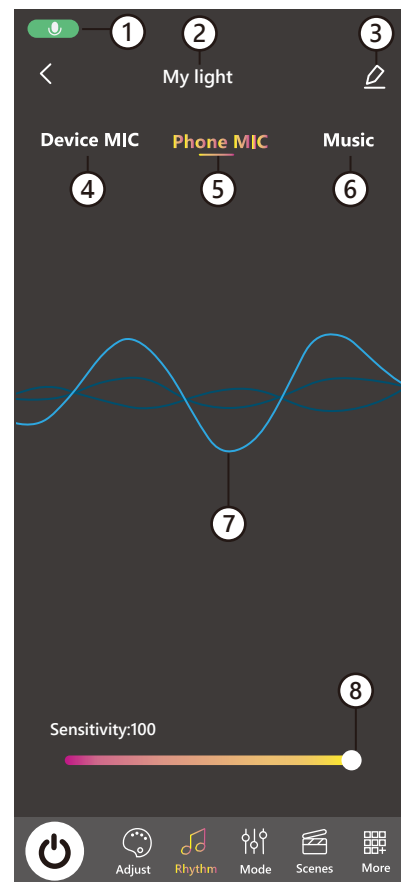

RHYTHM MODE-MUSIC MIC

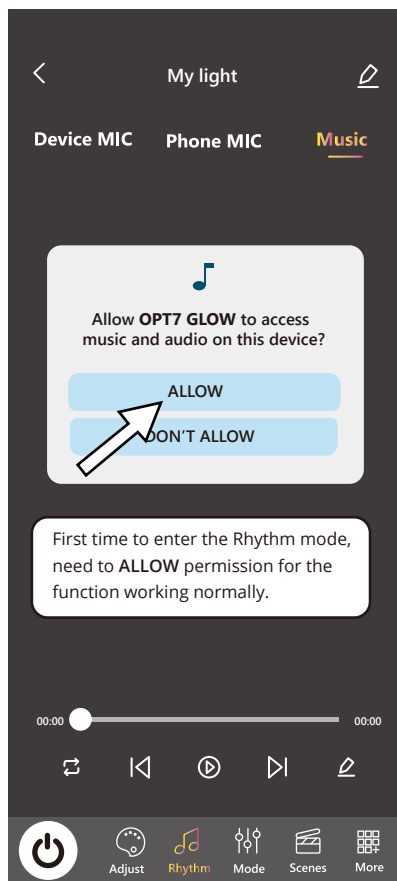

INTRODUCTION

- 1: Playlist (9 built-in songs)
- 2: Media player
- 3: Edit the playlist

HOW TO USE PHONE MUSIC

ANDROID

The music files on the phone will be imported into the playlist automatically.

IOS

Need to connect to iTunes on a computer to download the music file to the iPhone.

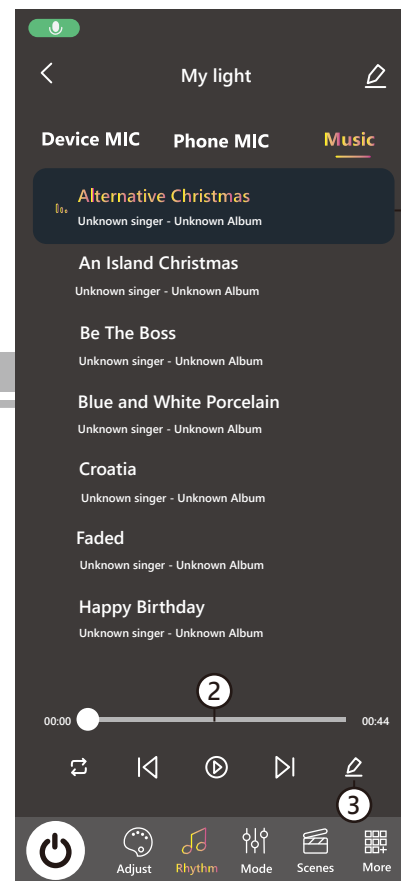

RHYTHM MODE

ANDROID SYSTEM

BACKGROUND PLAYING

The Phone MIC in the APP allows music to play in the background while users are using other Apps.

ANDROID SYSTEM

SPLIT SCREEN

The OPT7 GLOW supports the split screen function so keep both the music app and the OPT7 GLOW on the screen, the function will work.

IMPORTANT

- *The Phone MIC supports Android Auto only.
- *When using the Phone MIC, users must enable the background permissions.
- *Not all the cellphones support the split screen function.
- *Music supports only a device or a group at once.

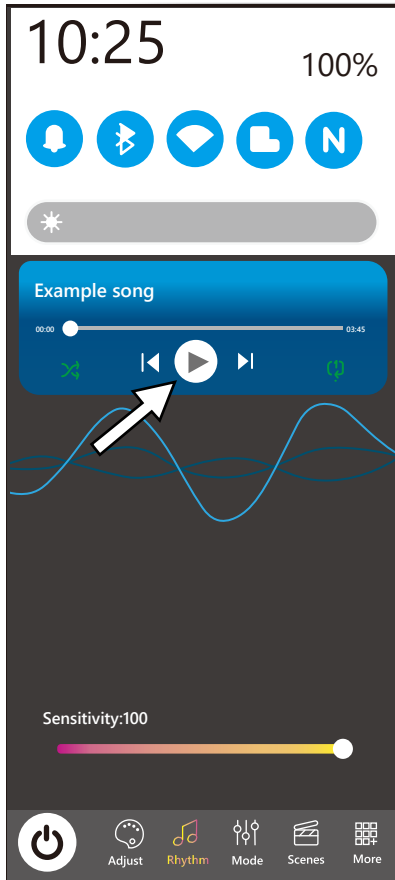
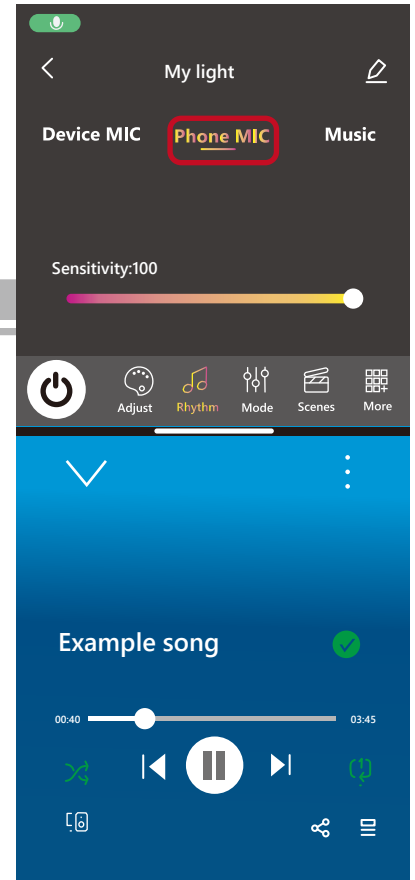

IOS SYSTEM

BACKGROUND PLAYING

The Phone MIC in the APP allows music to play in the background while users are using other Apps.

IMPORTANT

- *The Phone MIC does not support Apple CarPlay.
- *When using the Phone MIC, users must enable the background permissions.

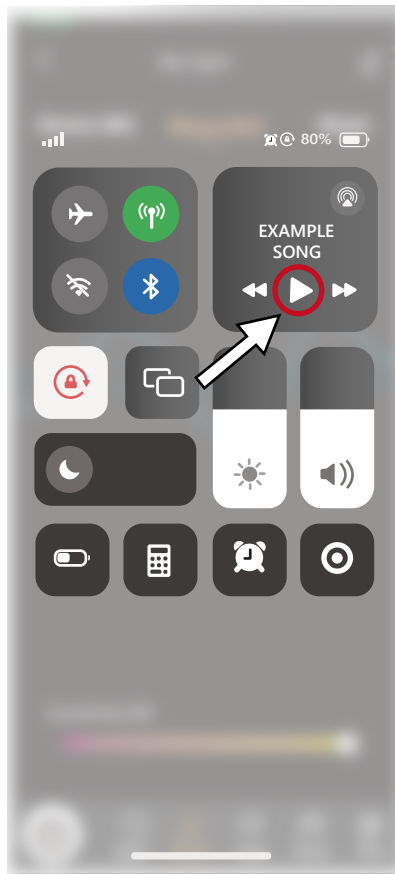
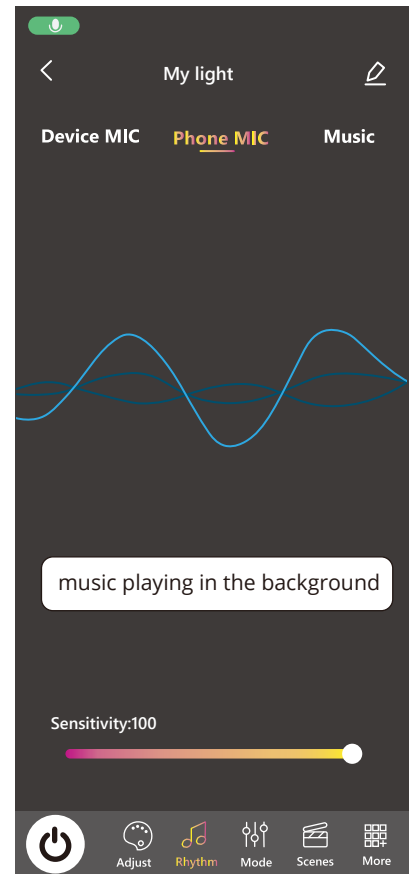

LIGHT MODE

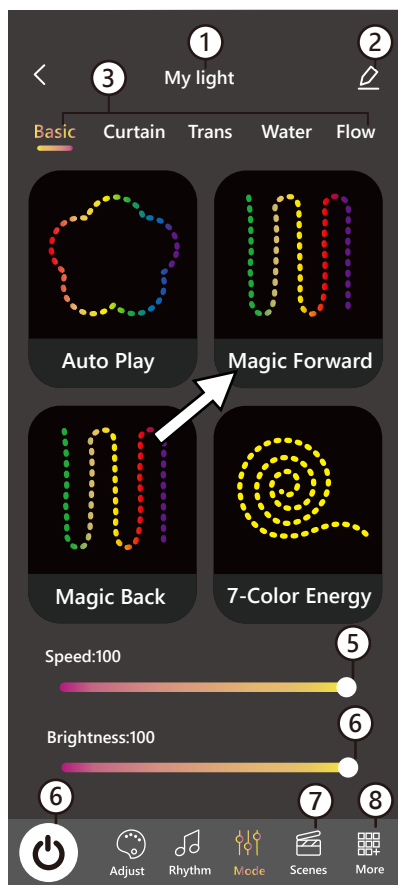

LIGHT MODE

INTRODUCTION

- 1: Device name
- 2: Device setting
- 3: Light mode catalog
- 4: Light mode with animation (touch one to set)
- 5: Speed adjust
- 6: On/Off
- 7: Scenes mode
- 8: More information

SCENES MODE

INTRODUCTION

- 1: Device name
- 2: Device setting
- 3: 4 scenes modes (touch to set the light mode not supposed to add one)
- 4: On/Off
- 5: More information

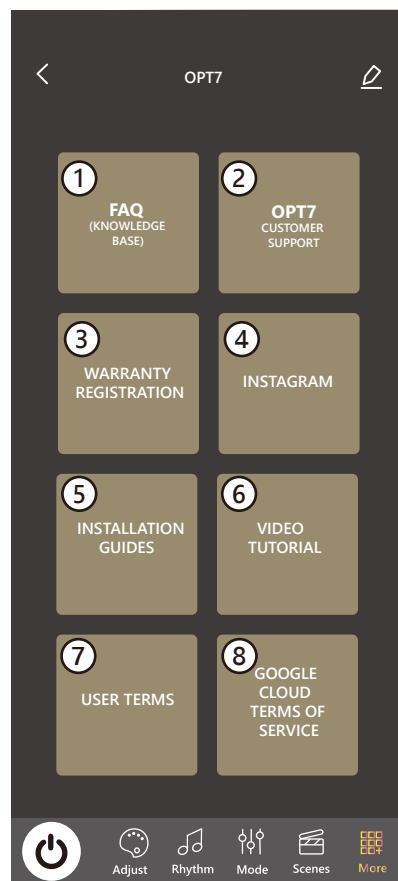
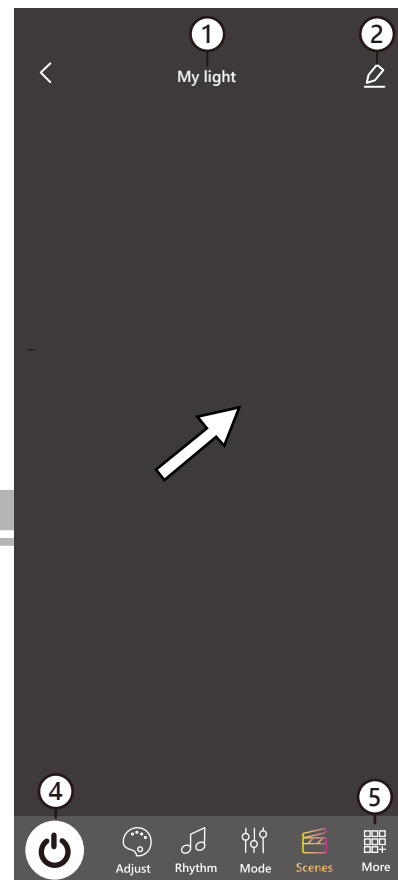

MORE INFORMATION

INTRODUCTION

1: FAQ (KNOWLEDGE BASE)

Access our Knowledge Base for comprehensive guides and instructional videos to support your installation requirements effectively.

2: OPT7 CUSTOMER SUPPORT

OPT7 offers comprehensive customer support, including assistance with your questions, technical issues, and app functionality.

3: WARRANTY REGISTRATION

Learn how to file a warranty claim and register your product for warranty.

4: SOCIAL MEDIA

Stay updated with OPT7 on social media for new tips, tricks, giveaways, and the latest information for auto enthusiasts.

5: INSTALLATION GUIDES:

Explore our install guides for a seamless experience.

6: VIDEO TUTORIAL

Subscribe to the OPT7 YouTube Channel for installation tutorials, product highlights, and more.

7: USER TERMS

Learn about our privacy policy and find out what information we collect when placing an order.

8: GOOGLE CLOUD TERMS OF SERVICE

HOW TO SET PIXEL

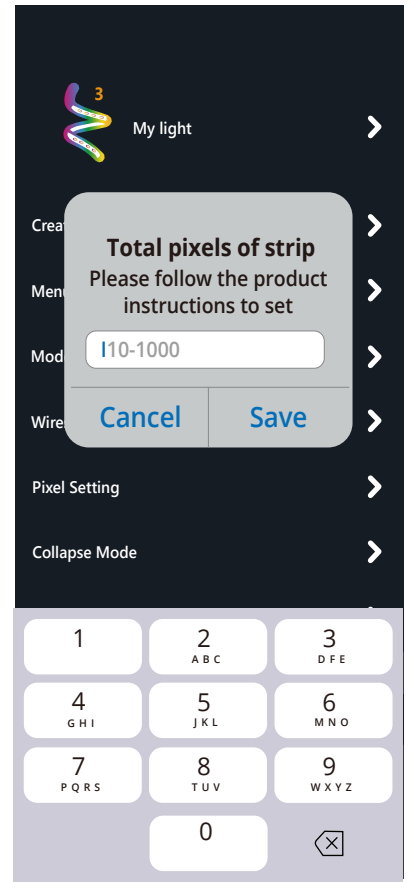
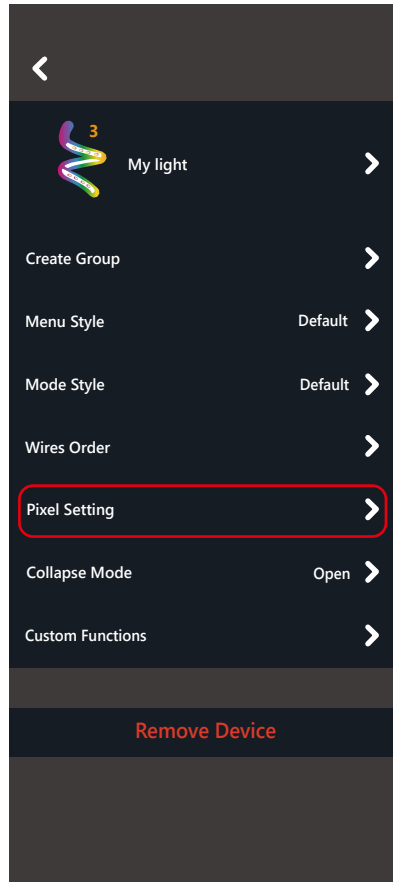

STEP 1

Ensure that the control box is properly connected then Click the icon  to enter Product Settings.

STEP 2

Click Pixel Setting to access the configuration.

STEP 3

Refer to the table below for the corresponding pixel values of the OPT7 product. Enter the correct values to ensure proper functionality.

IMPORTANT

- *Verify that the control box is correctly set up and connected to the app when setting the control box pixel
- *Only Dreamcolor series products require pixel adjustments.
- *Make sure to enter the correct pixel values corresponding to your product.
- *Incorrect values may cause the product to malfunction.
- *After setting the pixel, remember to pair the remote control.

OPT7 GLOW DREAMCOLOR SERIES

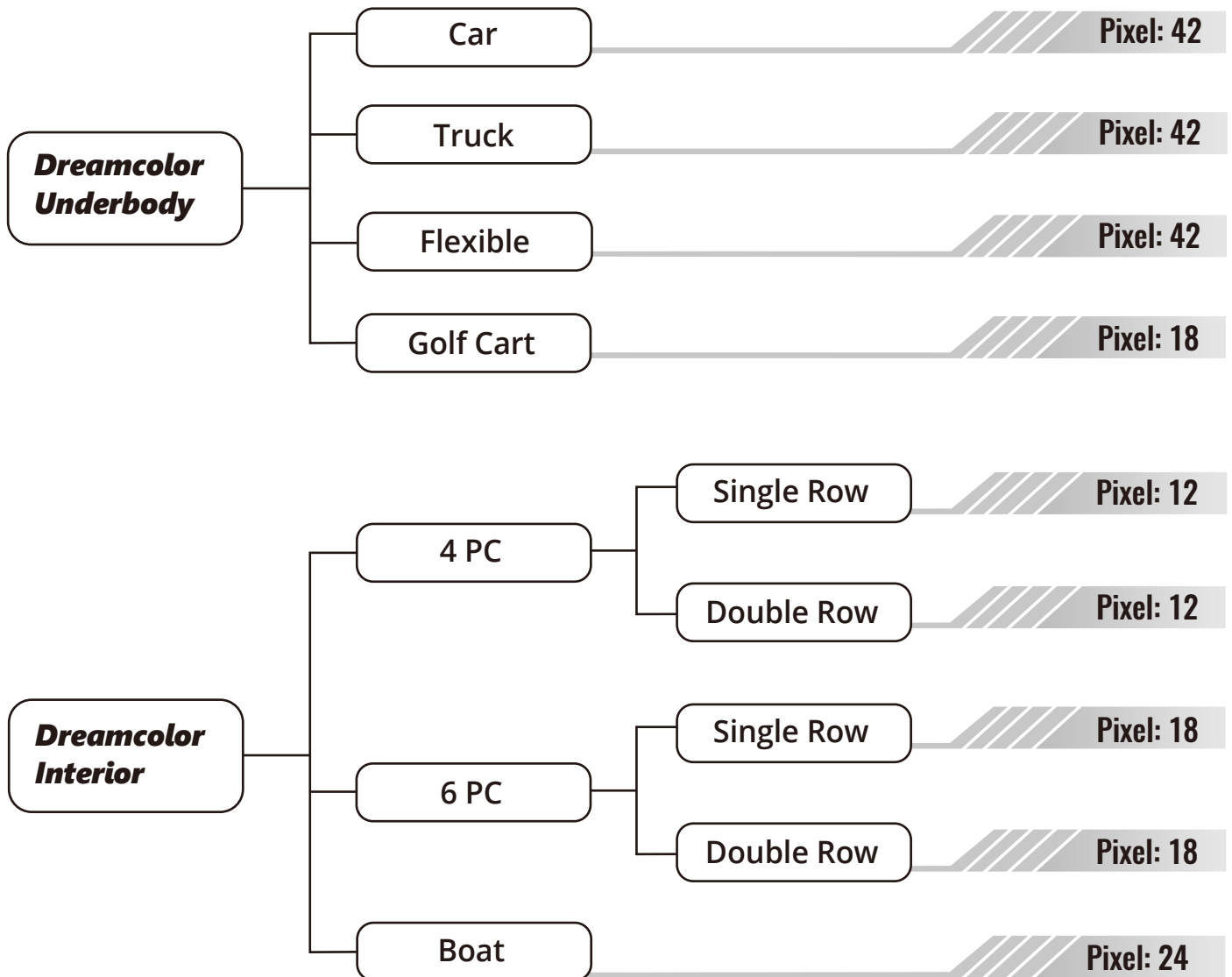

COLOR SETTING

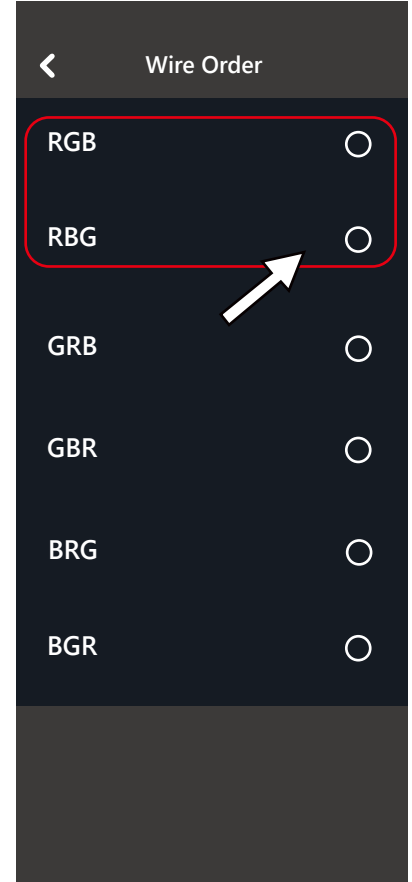
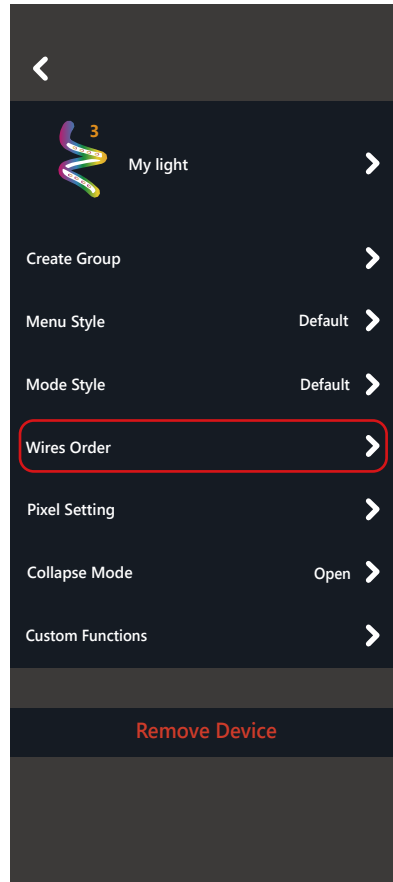

If you are having issues with color discrepancy between what's selected in the app and what the light kit actually displays. Here's a detail breakdown to remedy the issue.

STEPS

1. Open Setting

Navigate to the PENCIL Icon located in the upper right corner of the screen.

2. Access Wire Order Settings

In the settings, locate and select the option labeled WIRE ORDER.

3. Select the RGB as the Color Option.

Choose RGB as the color section. If selecting **RGB** results in incorrect colors, please switch to **RBG**.

*If the issue persists, please contact the OPT7 Support Team:

<https://www.opt-7.com/pages/customer-support>

DISCLAIMER

OPT7 Lighting is not liable for damages or personal injuries while installing this product. The Installation Guide is intended as assistance to reduce setup time. OPT7 Lighting assumes no responsibility for improper installation. If you are unfamiliar with your vehicle or inexperienced with aftermarket upgrades, please seek professional assistance.

OPT7 recommends installation for safety and guidance. Modified installations or installation recommendations not specified by OPT7 Lighting will void product warranty.