

## DISCLAIMER

OPT7 Lighting is not liable for damages or personal injuries while installing this product. The Installation Guide is intended as assistance to reduce setup time. OPT7 Lighting assumes no responsibility for improper installation.

If you are unfamiliar with your vehicle or inexperienced with aftermarket upgrades, please seek professional assistance.

OPT7 recommends installation for safety and guidance.

Modified installations or installation recommendations not specified by OPT7 Lighting will void product warranty.

**OPT7**

IGNITE INSPIRATION

# AURA™ CHOICE INTERIOR INSTALLATION GUIDE

## MAIN COMPONENTS

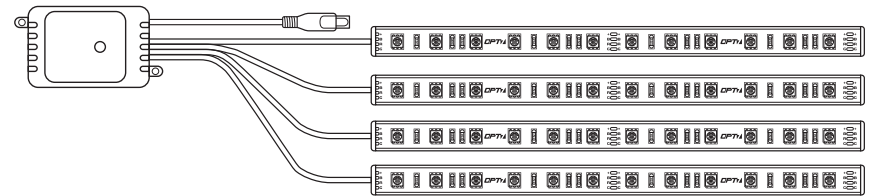

Light Bar: 8.85 x 0.55 x 0.36 inch

### AURA CONTROL KITS

Light Strip Wire Length: 49.21 inch x 2 pc  
68.89 inch x 2 pc

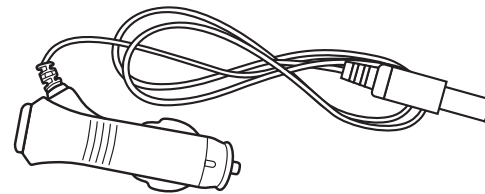

CIGARETTE LIGHTER POWER ADAPTER

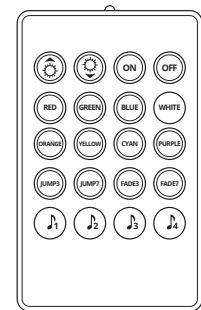

HAND HELD REMOTE

**OPT7**

# INSTALLATION

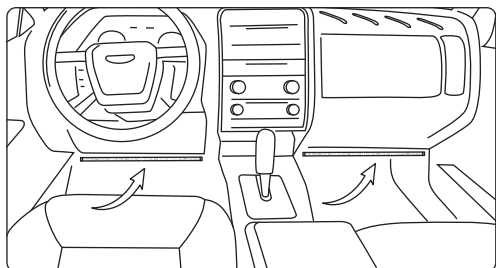

## STEP 1

Decide where to locate the light strips and ensure wiring has enough length for control box to be installed in desired location.

Once connected, plug the control box Cigarette Power Adapter into an available 12 volt charging port.

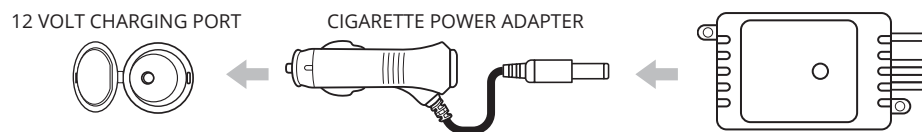

## STEP 2

Secure control box in desired location.

But ensure that the protruding IR sensor and Sound sensor are placed in a direct line of contact with the remote.

Ensure the control box is safely and securely hidden from exposing elements of moisture.

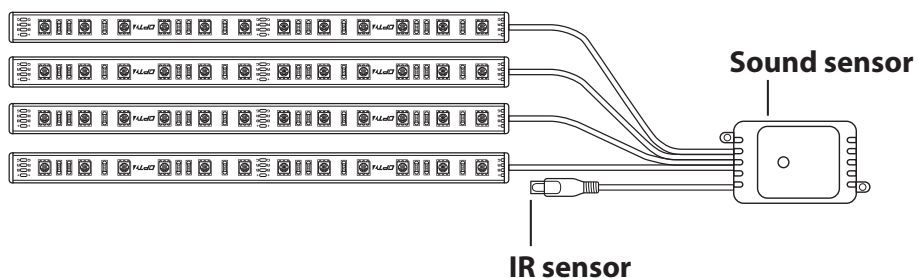

**OPT7**

## STEP 3

Thoroughly clean the surface where you plan on mounting the LED strip with rubbing / isopropyl alcohol. (This part is essential for a firm and long lasting placement. A dirty surface will prevent the strip from attaching firmly.)

Tear off the 3M Double-sided tape and firmly press the LED strip to the mounting area and hold for 3 seconds.

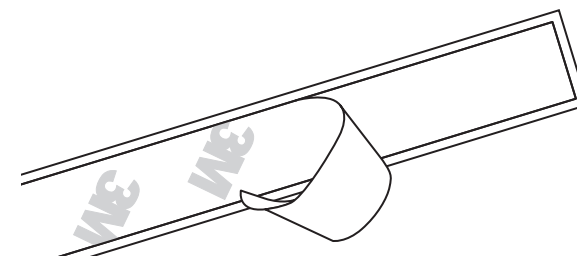

## STEP 4

Using the included E-Z Remote, select your desired color or pattern.

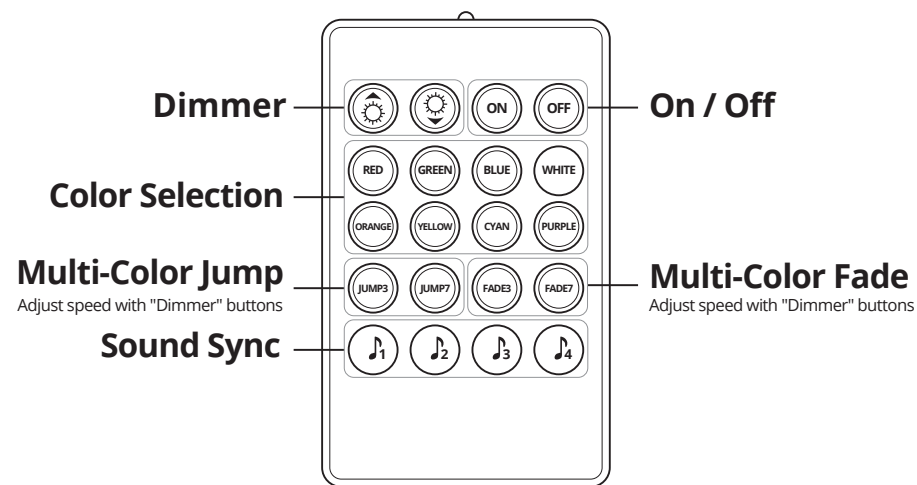

**OPT7**