





## Remote



## SLR-Hue Mixer™ Create and save custom colors.

1. Press any  Button.
2. Use the    to adjust each primary color.
3. Custom colors will automatically save.



## ProjectPak™ Compatible

Each ColorBloom kit can be cut, extended, expanded and adapted for complete customization. SLR ProjectPaks™ are project specific kits that include additional parts and accessories to simplify each project. Detailed guides are included with each ProjectPak™.



### Popular ProjectPaks:



- Over/Under Cabinet ProjectPak with Motion Sensor
- Inner-Cabinet ProjectPak with Motion Sensor
- Bed-Frame ProjectPak with Motion Sensor
- TV Backlight ProjectPak
- Cube Organizer/Shelf ProjectPak
- Bathroom ProjectPak

# LED HOME COLORBLOOM

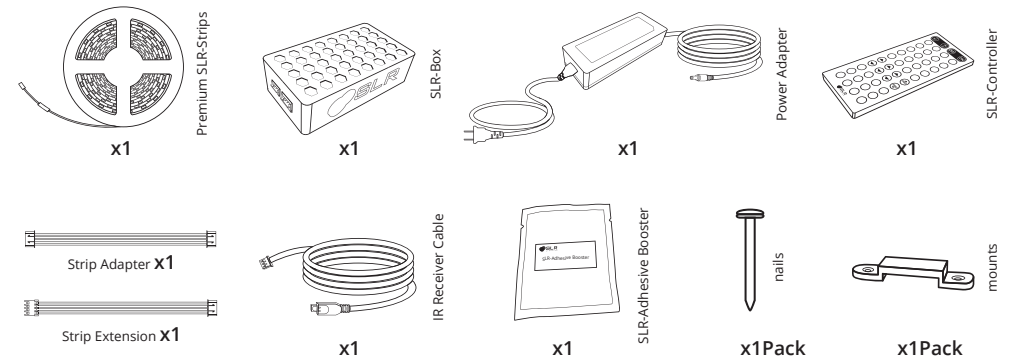
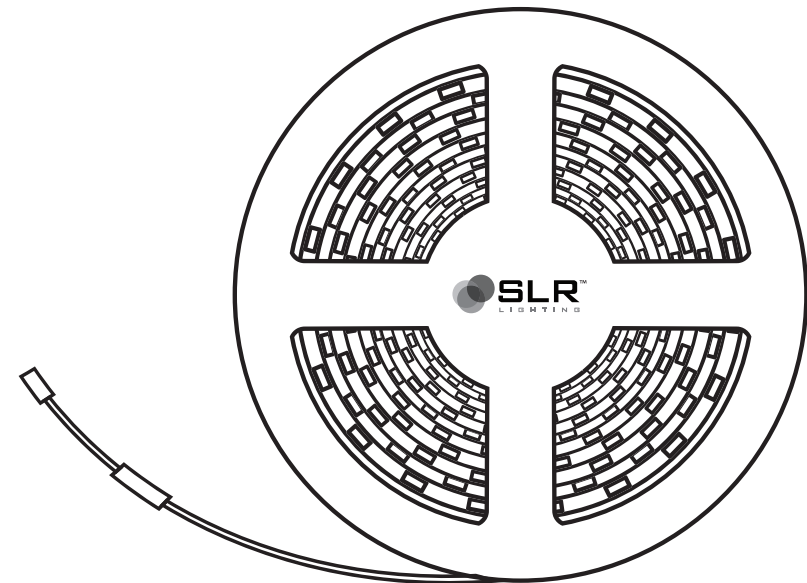

## Preparation

1. Unroll SLR-Strips.
2. Test multiple lighting locations using masking tape to hold SLR-Strips in place.
3. Clean surface for secure mounting and allow time to dry.
4. Apply the SLR-Adhesive Booster onto the mounting surface and allow time to fully dry.

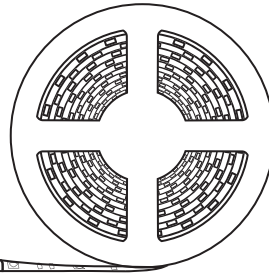

## Mounting

1. Peel off the tape backing to expose the adhesive. Avoid touching the adhesive side of the tape to ensure maximum bonding.
2. Lightly apply the SLR-Strips one section at a time while carefully ensuring that there are no gaps between the strip and the mounting surface.
3. Apply even pressure for about 10 seconds complete the bonding between the strip and mounting surface. Continue this process along the full length of the SLR-Strip.
4. For mounting on wood or drywall surfaces, use the SLR-Mounts to permanently secure the SLR-Strips in place. This step is optional, but recommended for cabinetry and outdoor usage.

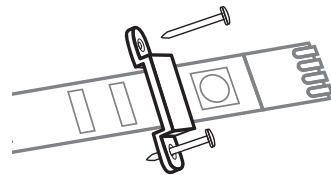
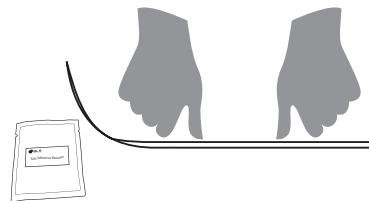

## Connecting

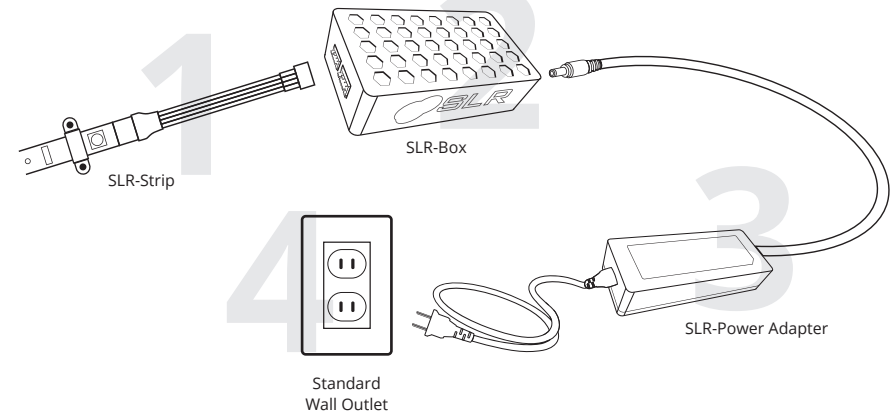

## IR Receiver Cable

1. Connect IR cable to the SLR-Box.
2. Run the IR cable to an open area that faces the center of the room.
3. Use tape (not included) to secure the IR cable receiver end so that it faces the center of the room. The IR Receiver must have a direct line of sight of the SLR-Controller to function properly.

