

REDLINE

EASY CONNECT

EXPANSION

ADAPTER

FOR FORD F150 2021-2023 HALOGEN
WITH BLIS/BACKUP CAMERA/ASSIST SENSOR

**Hello Fellow OPT7-ites, Introducing the Redline Easy Connect Harness to Flat
4-Pin Extension Adapter Harness**

The OPT7 Redline Easy Connect Expansion Adapter Harness is purpose-built to be used as a trailer accessory for 20-23 F150 /w BLIS. It provides a plug-and-play style that allows you to quickly, seamlessly and virtually hidden installation without cutting or splicing your factory harnesses.

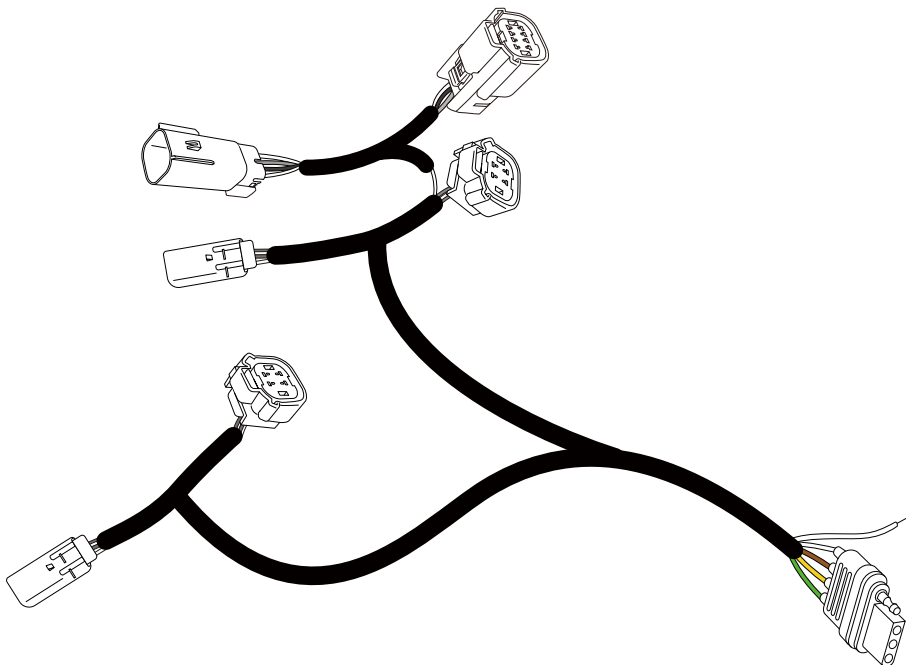

INSTALLATION

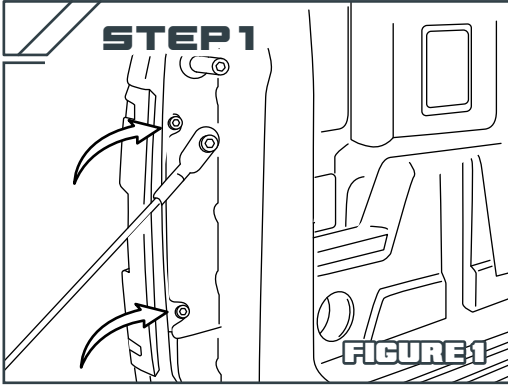

Open up your tailgate first.

Next, locate the two bolts that lock the tail light (See Figure 1) and loosen them.

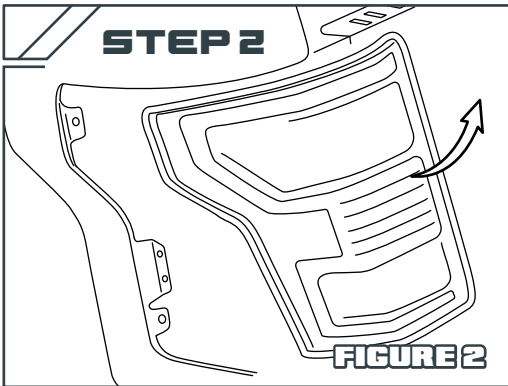

Slowly move the loose tail light until it is completely removed (See Figure 2).

IMPORTANT

There are two plastic clips on the inside of the tail light for fixing, please be careful not to break it when removing it.

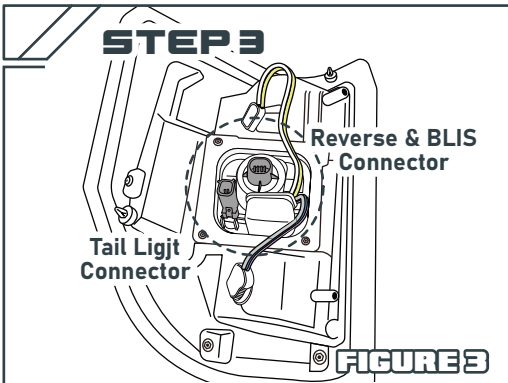

Locate the OEM wiring harness (See Figure 3) and unplug it from the tail light assembly by lightly pressing the Release-Latch on the connector.

IMPORTANT

Only the driver's side must plug the two connectors to get the reverse light signal.

HOW TO CONNECT PNP EXPANSION ADAPTER TO YOUR TAILLIGHTS

OEM TAIL LIGHTS

RIGHT

Passenger Side



Tail light Connector



OEM Wiring Harness

LEFT

Driver's Side



Tail light Connector



OEM Wiring Harness

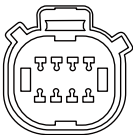

Reverse & BLIS
Connector

STEP 4

To make it easier for you to identify the signal location represented by the Connector/Wiring. Please read the relevant wiring instructions carefully before commencing any work. (See Figure 4)

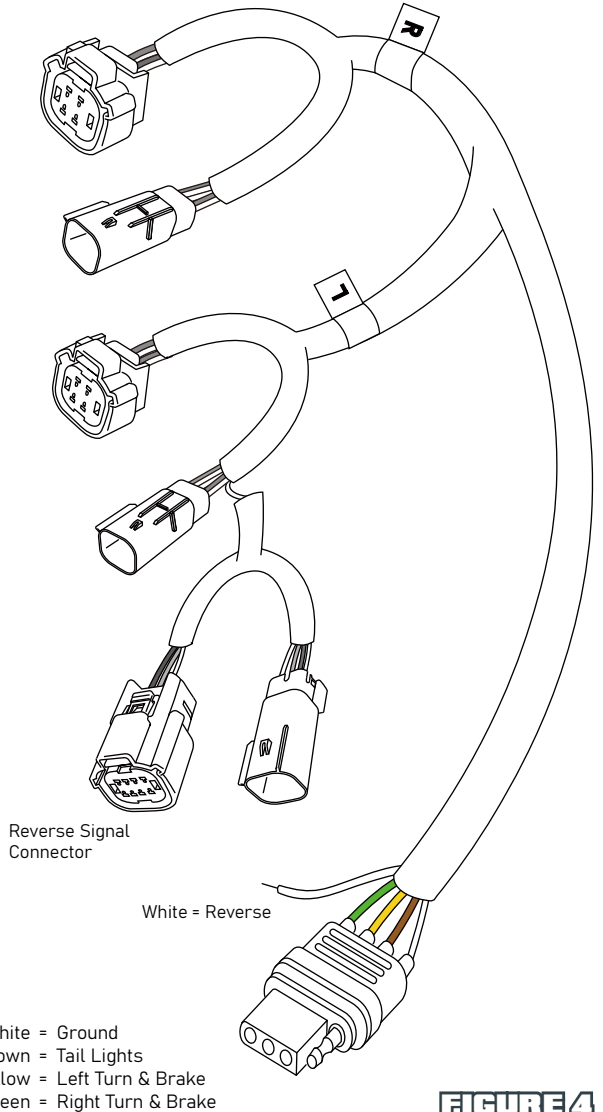
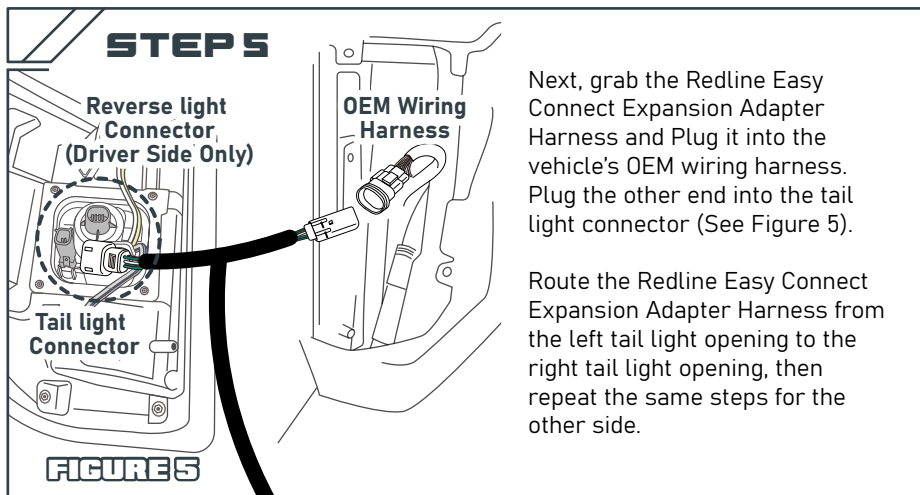

FIGURE 4

INSTALLATION



STEP 6

Use some zip ties to secure the flat 4PIN trailer connector and reverse wire in place along the inner bumper.

STEP 7

To complete the installation, connect the tailgate light bar to the 4-pin trailer connector on the Easy Connect Harness. Use the provided scotch lock to securely hardwire the reverse (white) wire to the tailgate light bar for full functionality. Once connected, test all functions to ensure they are working properly.

DISCLAIMER

OPT7 Lighting is not liable for damages or personal injuries while installing this product. The Installation Guide is intended as assistance to reduce setup time. OPT7 Lighting assumes no responsibility for improper installation. If you are unfamiliar with your vehicle or inexperienced with aftermarket upgrades, please seek professional assistance.

OPT7 recommends installation for safety and guidance.

Modified installations or installation recommendations not specified by OPT7 Lighting will void product warranty.