

# AURA™

# SNOWMOBILE

## INSTALLATION GUIDE

### MAIN COMPONENTS



LIGHT STRIPS

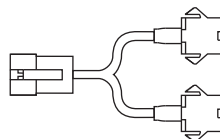

Y- SPLITTERS



AURA CONTROL BOX

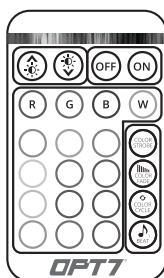

HAND HELD REMOTE

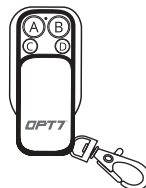

KEYCHAIN REMOTE



VARIOUS EXTENSION WIRES

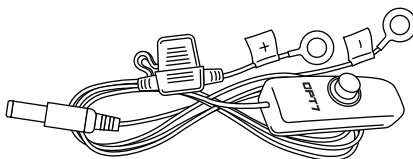

POWER HARNESS WITH ON/OFF SWITCH

# INSTALLATION

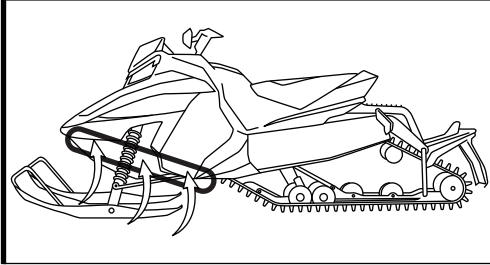

## STEP 1

Decide where to locate the light strips and ensure wiring has enough length for control box to be installed in desired location.

## EXAMPLES

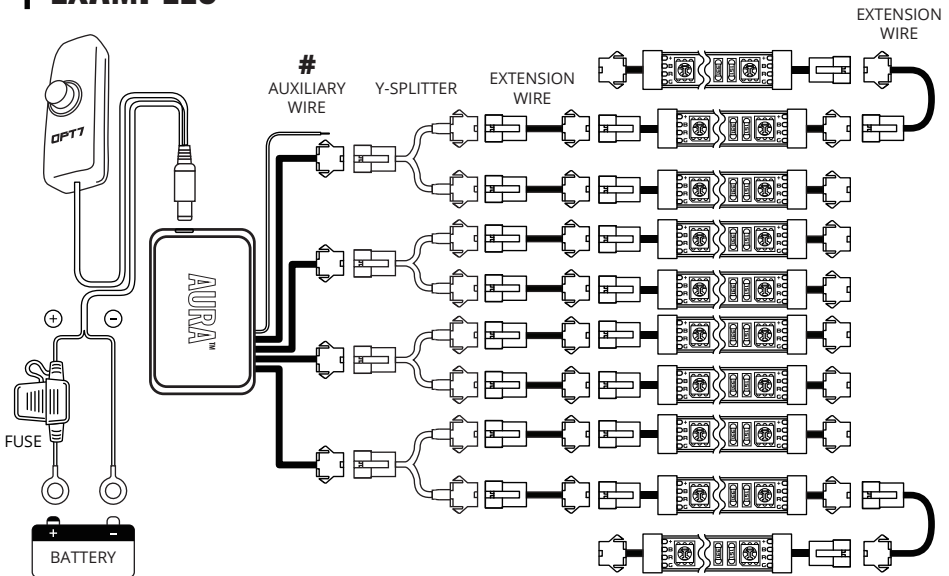

### IMPORTANT NOTE!! Before You Start

We provide multiple sets of extension wires for you to configure. You can quickly extend them wherever you want to install.

### # AUX WIRING FOR A BRAKE LIGHT

This feature will activate when the aux wiring is connected to the trigger wire for **positive(+) wire of brake light**.

### NOTE

The default color is "RED" so that when you apply the brake, it will also sync with the brake light.

# INSTALLATION

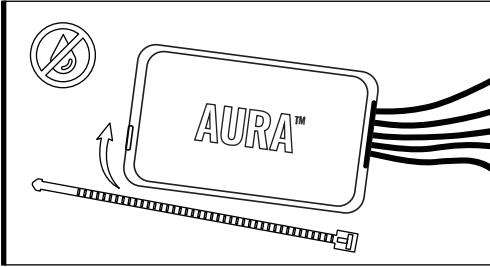

## STEP 2

Secure Control box in desired location with Velcro or zip ties.

\* CONTROL BOX NOT WATERPROOF  
Ensure the control box is safely and securely hidden from exposing elements of moisture.

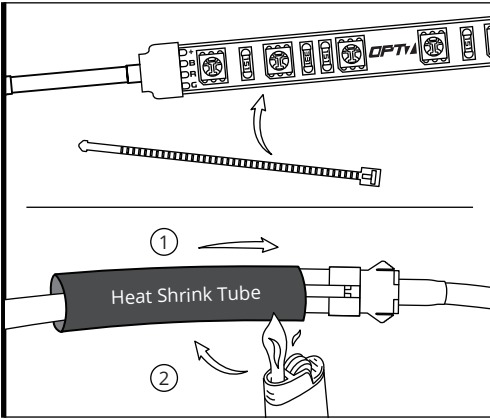

## STEP 3

Secure the light strips using the zip ties to tie all the wiring away from the moving components.

### \* IMPORTANT:

The LED connectors are not waterproof. You will need to use HEAT SHRINK TUBE or ELECTRICAL TAPE around the LED connectors to ensure the longevity of the lighting kit.

## STEP 4

Using the included E-Z Remote or Keychain Remote to select your desired color or pattern.

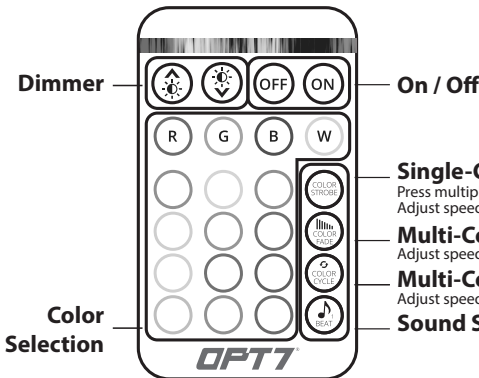

**Single-Color Strobe**  
Press multiple times to change color  
Adjust speed with "Dimmer" buttons

**Multi-Color Fade**  
Adjust speed with "Dimmer" buttons

**Multi-Color Cycle**  
Adjust speed with "Dimmer" buttons

**Sound Sync (Disable)**



**A ON/OFF**

**B Color Selector**

Supports 16 sets of solid color changes

**C Dimmer Up/Down**

Supports 4 levels of brightness adjustment

**D Disable** (X)

## | AUX WIRING FOR A DOOR/DOME LIGHT



Please scan to see a detail instruction on Door Assist Sync or go to <https://wintis.ladesk.com/549690-AURA-Door-AssistAUX-Installation-Guide>

## | OPTIONAL UPGRADE

Upgrade your Aura Original Control Box to the Aura Pro Bluetooth Control Box. All new AURA Pro Bluetooth is App enabled by a smartphone controller (iOS & Android Compatible).

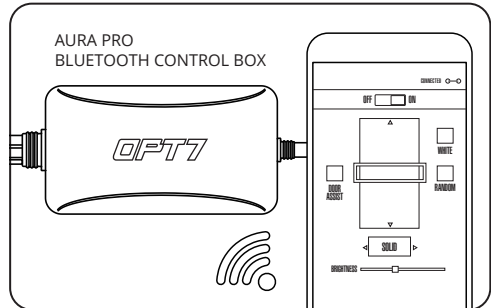

## | DISCLAIMER

OPT7 Lighting is not liable for damages or personal injuries while installing this product. The Installation Guide is intended as assistance to reduce setup time. OPT7 Lighting assumes no responsibility for improper installation. If you are unfamiliar with your vehicle or inexperienced with aftermarket upgrades, please seek professional assistance.

OPT7 recommends installation for safety and guidance.

Modified installations or installation recommendations not specified by OPT7 Lighting will void product warranty.