

OPT7[®]

ROCK LIGHTS 5 PIN ON/OFF

ROCKER SWITCH

WITH JUMPER WIRES

INSTALL GUIDE

COMPONENTS

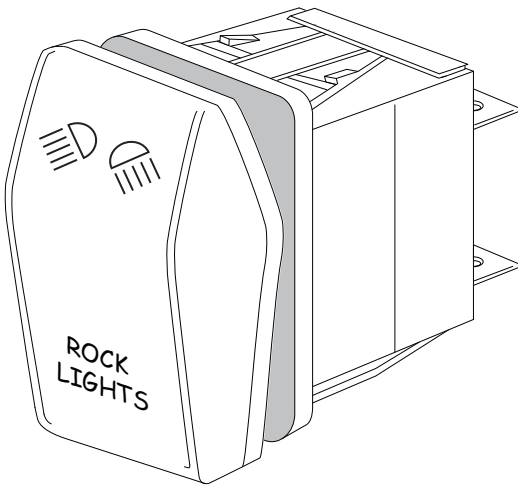

ROCKER SWITCH

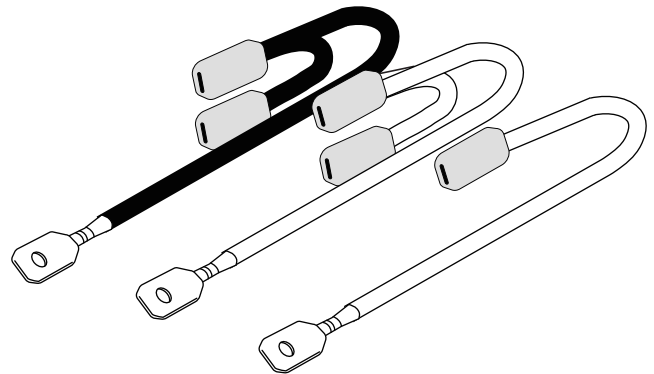

JUMPER WIRES

SPECIFICATIONS

Input Voltage
Input Power
LED Color Options
Temperature

DC 12V
Max 2.4Watts per pod
White, or Blue, or Green
-5°F - 120°F

OPT7[®]

INSTALLATION

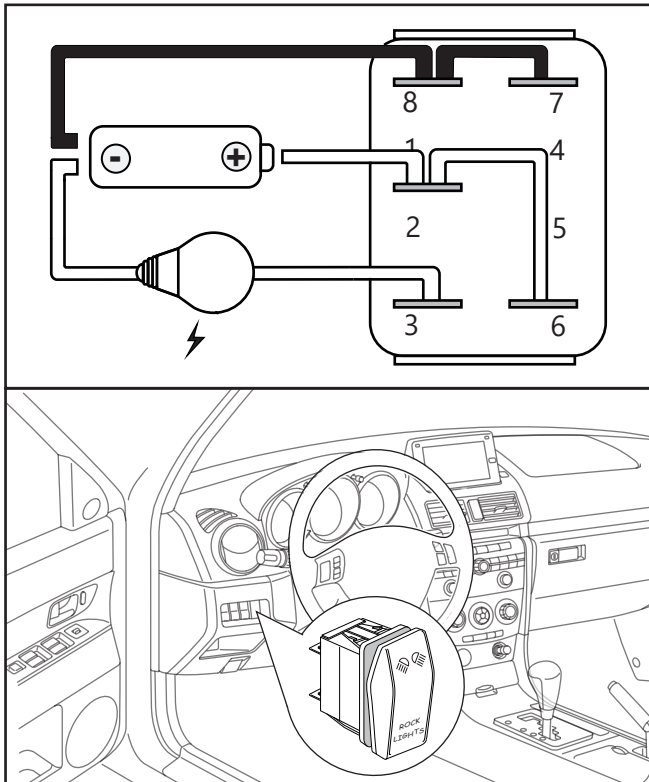

STEP 1

Follow the wiring method :

When the lower LED is on when Power on
When the upper LED is on when Switch on.

STEP 2

Find an appropriate place to install.

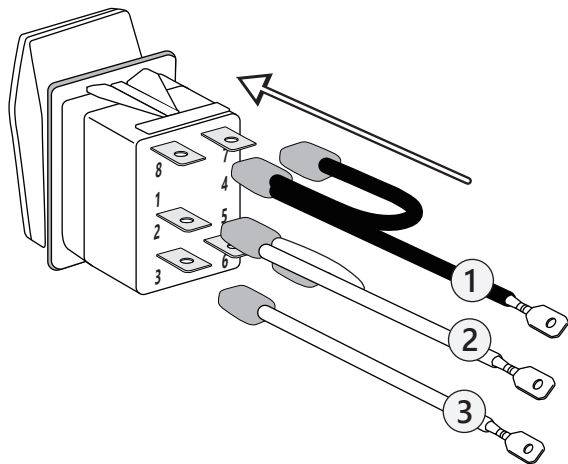

STEP 3

1. Connect the black jumper wire to the port 7 and 8.
2. Connect the red jumper wire to the port 2 and port 6 .
3. Connect the red jumper wire to the port 3.

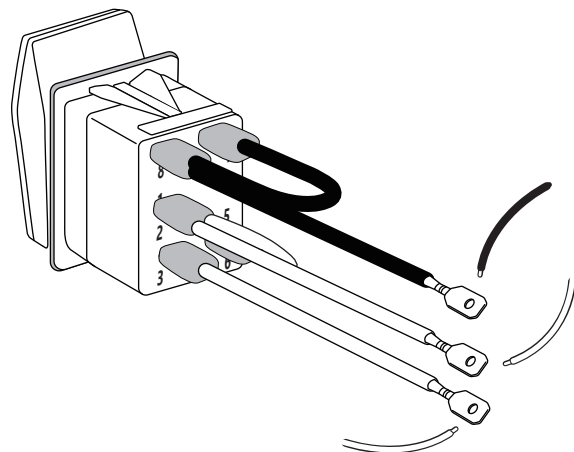

STEP 4

Confirm all the ports are connected and then connect the ports to the wires.

DISCLAIMER



If you are uncomfortable performing work of this nature yourself, then do not hesitate to consult a professional for help. Working with a vehicle's electrical system can be hazardous to an unqualified individual. OPT7 is not liable for damages or personal injuries while installing this product. The installation guide is provided as assistance to reduce set up time.

OPT7 Lighting is not liable for damages or personal injuries while installing this product. The Installation Guide is intended as assistance to reduce setup time. OPT7 Lighting assumes no responsibility for improper installation. If you are unfamiliar with your vehicle or inexperienced with aftermarket upgrades, please seek professional assistance.

OPT7 recommends installation for safety and guidance. Modified installations or installation recommendations not specified by OPT7 Lighting will void product warranty.