

**OPT7<sup>®</sup>**

# **SIDEKICK RUNNING BOARD**

**WITH WARNING LIGHT BAR ON/OFF SWITCH**

INSTALLATION MANUAL

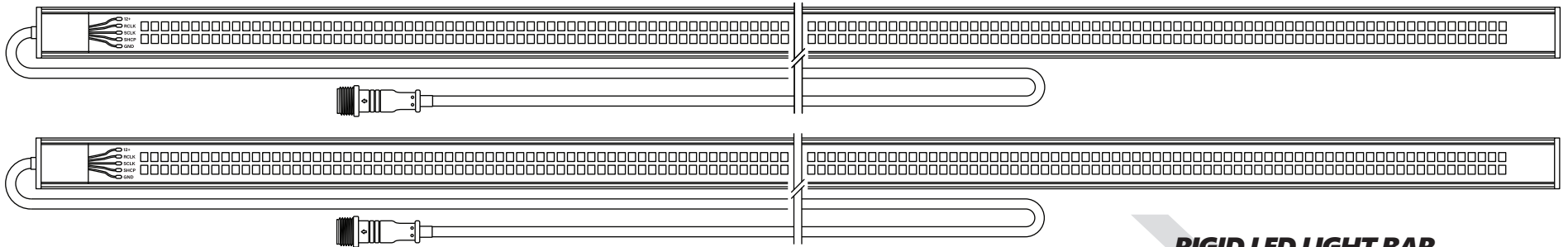

**RIGID LED LIGHT BAR**

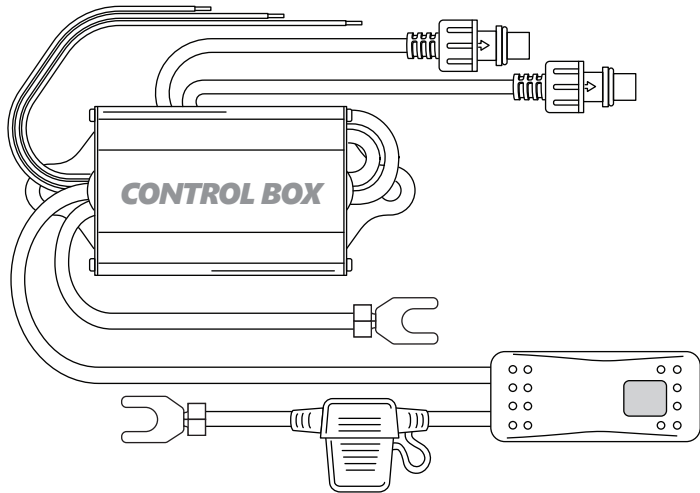

**CONTROL BOX WITH SWITCH**

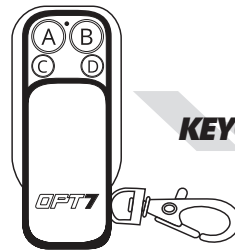

**KEYCHAIN REMOTE**

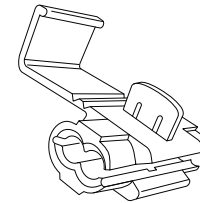

**SCOTCHLOKS**

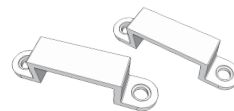

**BRACKETS**



**ADHESIVE BOOSTER**

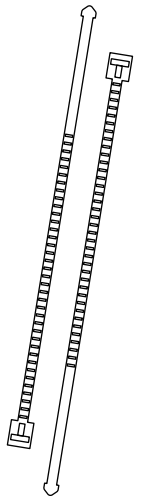

**ZIP-TIES**

## **WHAT'S INCLUDED**

# INSTALLATION

**STEP 1** Open the package, and verify all the includes parts are received prior installation.

**NOTE**

Please ensure to perform a bench test on light bar through the control box before installing it on your vehicle.

**STEP 2** Thoroughly clean the surface area you will be mounting the LED light bar. (A dirty surface will prevent the LED bar from attaching firmly and securely.)

**STEP 3** Wipe the mounting area with the included adhesive booster.

**STEP 4** Wipe the mounting area with the included adhesive booster, peel off the backing tape, apply the light bars to the desired location, and for extra security, use the included mounting brackets to drill and fasten the light bar.

**OPTIONAL** Use the provided brackets to strengthen the hold with screws.

**STEP 5** Next, find your vehicle's corresponding wiring as shown below to power the unit.

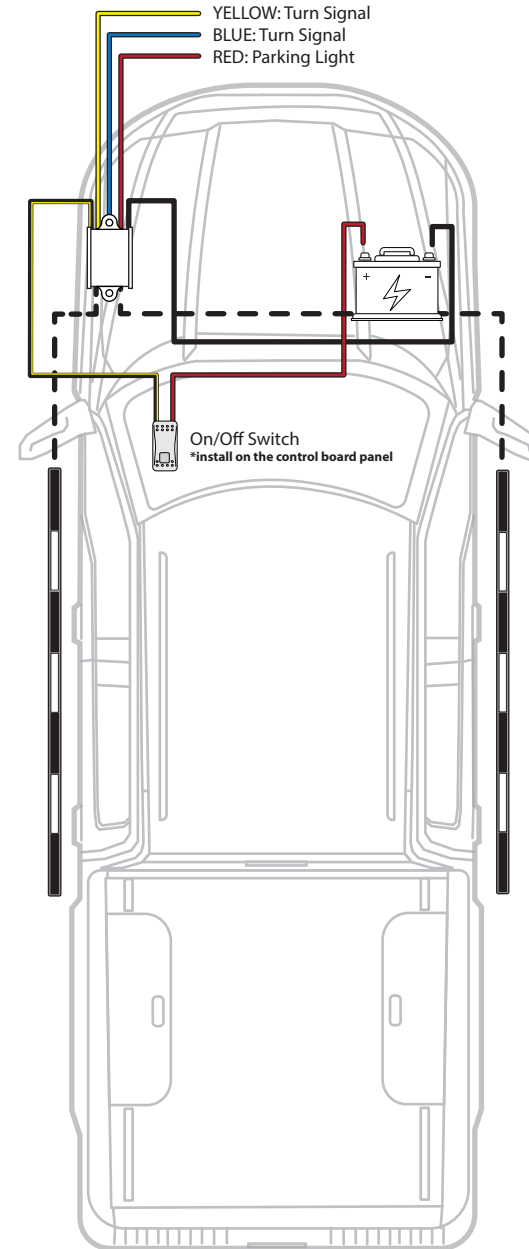
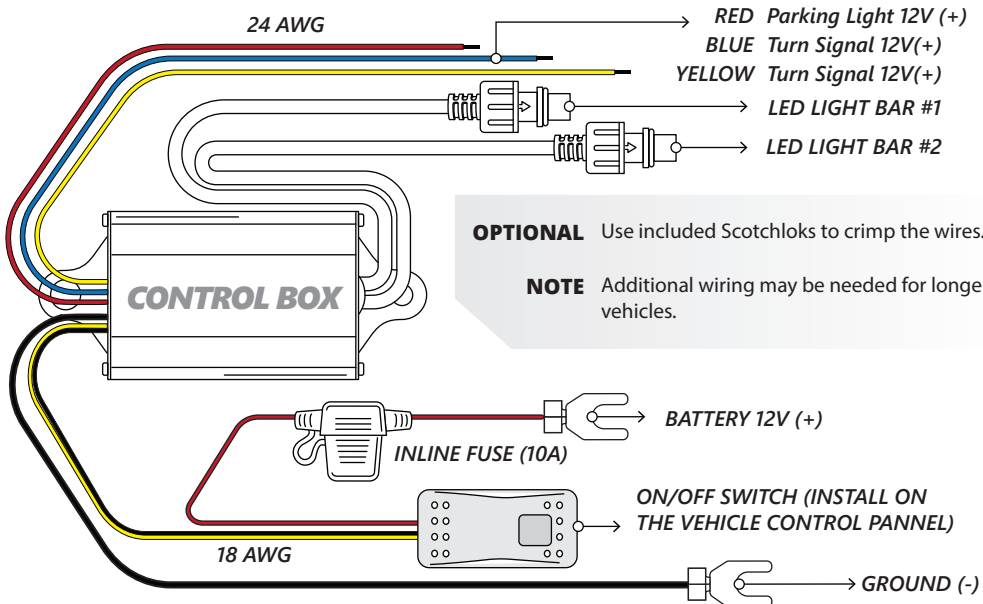

**WIRE AND INSTALL LOCATION SUGGESTION**

# INSTALLATION

## ⚠ IMPORTANT ⚠

**BE SURE TO CONFIRM THE CORRECT DIRECTION OF THE ARROW!!  
TO AVOID PRODUCT DAMAGE DUE TO INCORRECT INSTALLATION.**

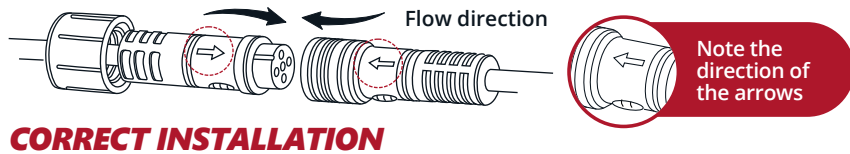

**STEP 6** Switch install location suggestion :  
\*Must follow the color to connect the wire and the switch.

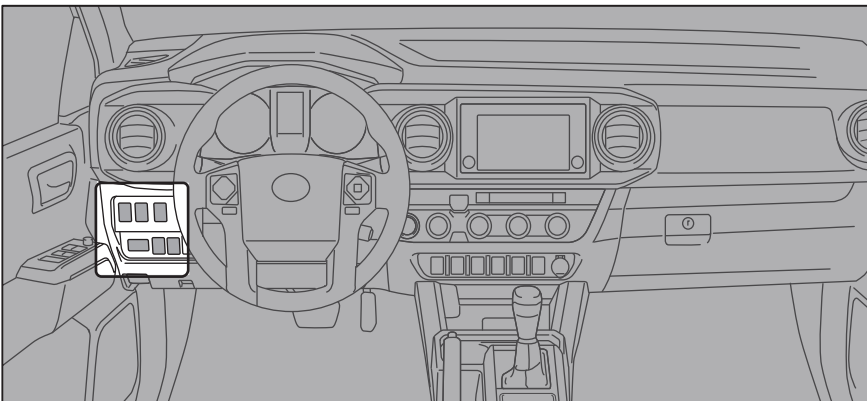

Find the available position on the control panel of the vehicle.

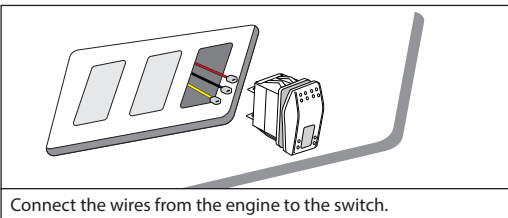

Connect the wires from the engine to the switch.

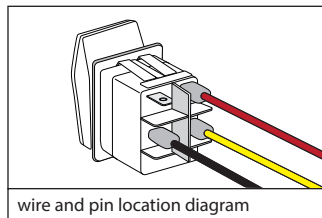

wire and pin location diagram

## HOW TO USE THE WARNING LIGHT FUNCTION

Press the "A" button to enable the warning light function. You may easily switch between modes using the B,C,D on the RF remote.



**A** Power ON/OFF

**B** Adjust Speed (H/M/L)

**C** Mode Up (5 Level)

**D** Mode Down (5 Level)

### NOTES

- 1 Swipe the lid down to use the 4 key button to control the lights.
- 2 Ensure to use this product within 10M/33FT or more.
- 3 When the Warning Lights are activated, the vehicle's signal reception will be temporarily disabled and will only be restored once turned off.

**STEP 7** Ensure all the function and the remote control work normally after installing the switch and the warning light bar.

## DISCLAIMER

OPT7 Lighting is not liable for damages or personal injuries while installing this product. The installation Guide is intended as assistance to reduce step time. OPT7 Light assumes no responsibility for improper installation. If you are unfamiliar with your vehicle or inexperienced with aftermarket upgrades, please seek professional assistance.

OPT7 recommends installation for safety and guidance. Modified installations or installation recommendations not specified by OPT7 Light will void product warranty.