

AURA™

DRL HALO RGB

DODGE CHALLENGER 08-23

INSTALLATION GUIDE

COMPONENTS



LIGHT STRIPS X4

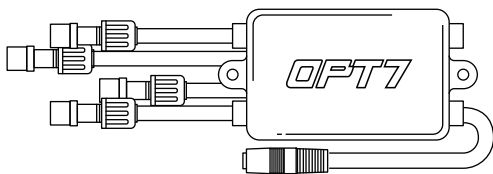

AURA CONTROL BOX

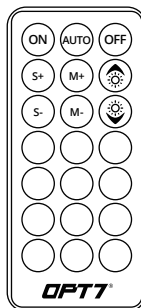

REMOTE

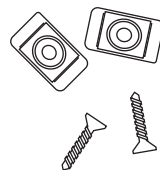

MOUNTING KIT

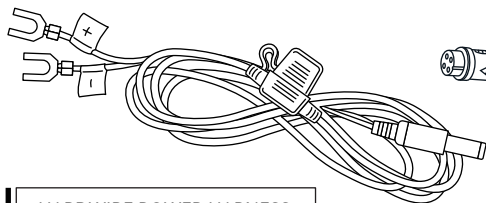

HARDWIRE POWER HARNESS

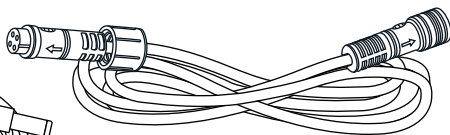

EXTENSION WIRES X4

INSTALLATION

STEP 1

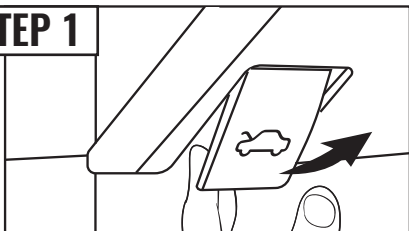

Open the hood.

STEP 2

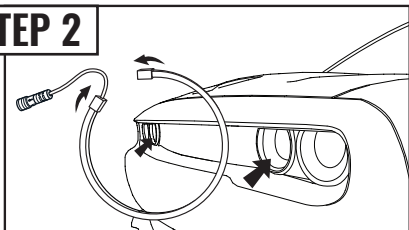

Wrap the LED strip into a circle shape and firmly press into place inside of the intake hole to secure.

OPTION #2

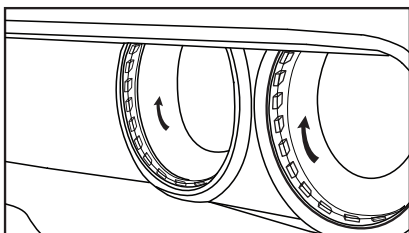

Attach the strip as pictured as an alternate method of install.

STEP 3

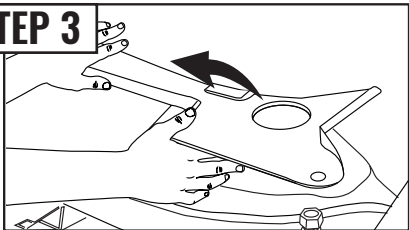

Remove the plastic covers on the right and left side of the engine bay.

STEP 4

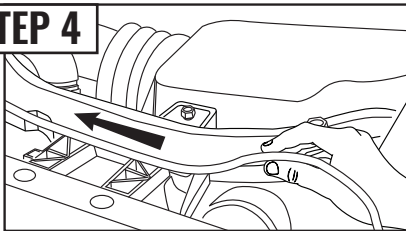

Run the wires along the front bracket and connect to the control box.

STEP 5

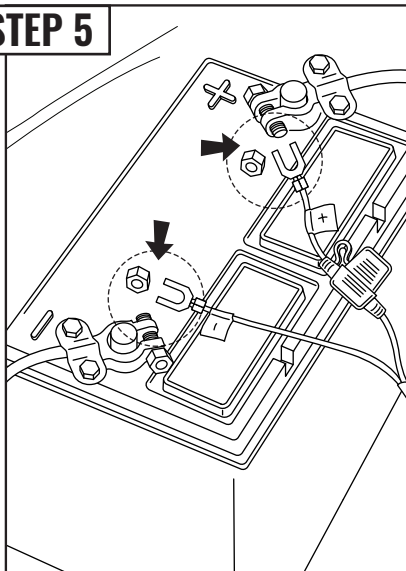

Connect the power wire harness to your vehicle's battery, making sure to route the wires properly, so the harness reaches the control box.

Note: On most Dodge Challengers, the battery is located in the rear of the vehicle. Please verify its location before installation.

INSTALLATION

OPTION #2

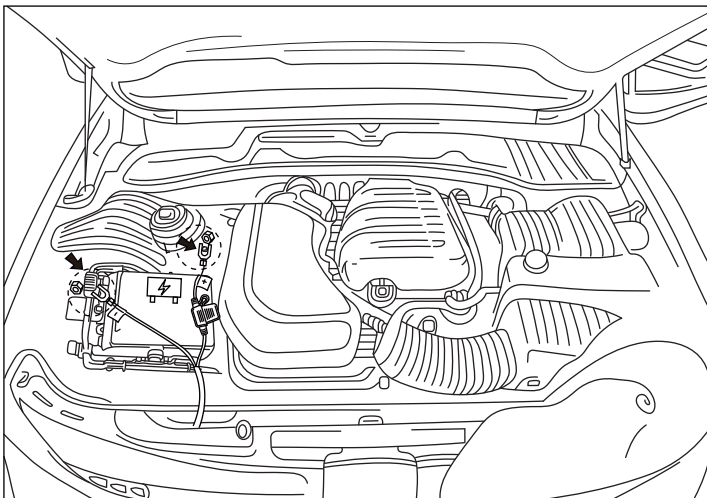

If your battery is located in the front engine compartment, you may install the power harness there as an alternative installation method.

STEP 6

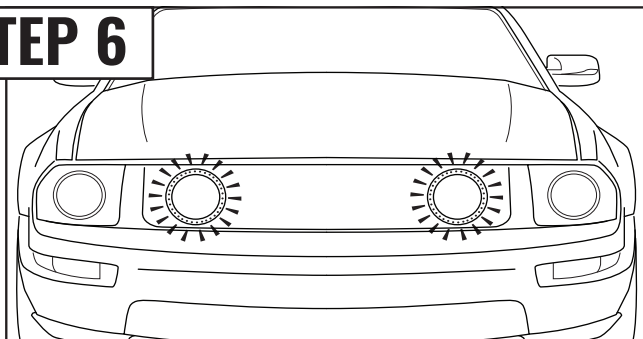

Test for function.

EXAMPLE

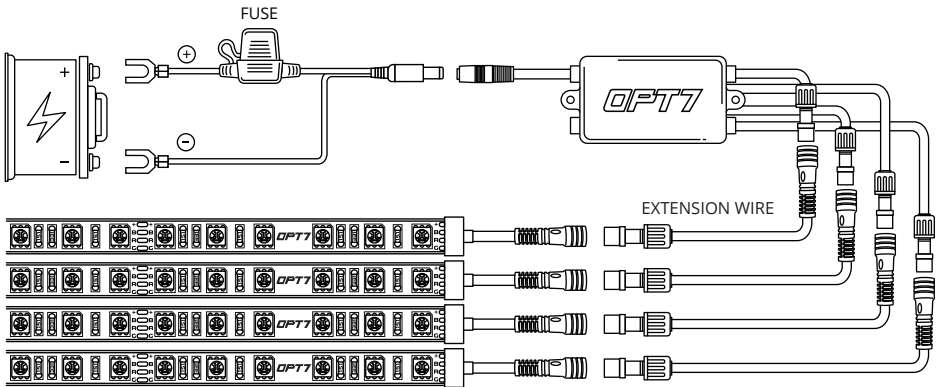

WARNING

1. Connecting to more than 10 AMP will override the kit and cause early failure, ensure it is 10 AMP or less!!
2. Please ensure that the LED bars or strips/control box/wiring all are mounted in areas where will not exceed 85°C or 185°F.

! IMPORTANT !

**BE SURE TO CONFIRM THE CORRECT DIRECTION OF THE ARROW!!
TO AVOID PRODUCT DAMAGE DUE TO INCORRECT INSTALLATION.**

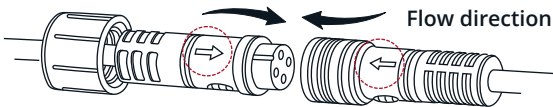

CORRECT INSTALLATION



Note the direction of the arrows

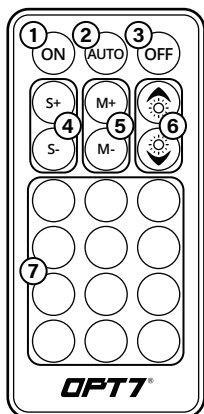

BUTTON LAYOUT

STEP 4

Using the included E-Z Remote, select your desired color or pattern.

- 1 Power-ON
- 2 Automatic Color Change
- 3 Power-OFF
- 4 Speed +/- **8 Levels**
- 5 Mode +/- **19 Mode**
- 6 Dimmer **8 Levels**
- 7 Color Selection **12 Colors**

DISCLAIMER

OPT7 Lighting is not liable for damages or personal injuries while installing this product. The Installation Guide is intended as assistance to reduce setup time. OPT7 Lighting assumes no responsibility for improper installation. If you are unfamiliar with your vehicle or inexperienced with aftermarket upgrades, please seek professional assistance.

OPT7 recommends installation for safety and guidance.

Modified installations or installation recommendations not specified by OPT7 Lighting will void product warranty.