

OPT7®

QUANTUM GLOW ROCK LIGHTS

INSTALLATION GUIDE

COMPONENTS

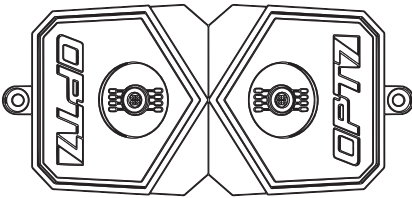

Quantum Rock Light Pod **x4**

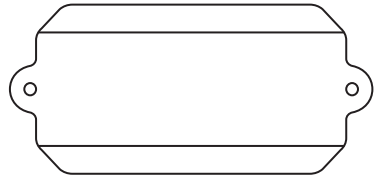

Rubber Pad **x4**

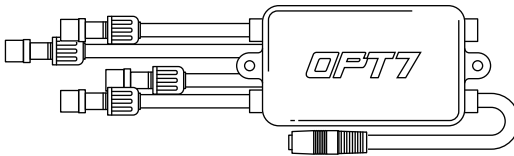

Control Box (Scan QR code for App User Guide) **x1**

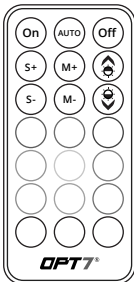

HAND HELD REMOTE **x1**

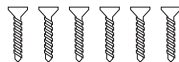

Metal Screw **x8**



10ft Extension Cable **x6**

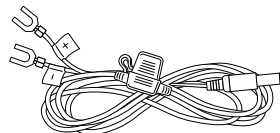

Hardwire Power Harness **x1**

WHERE TO INSTALL

RECOMMENDED LOCATIONS FOR ROCK LIGHT PODS

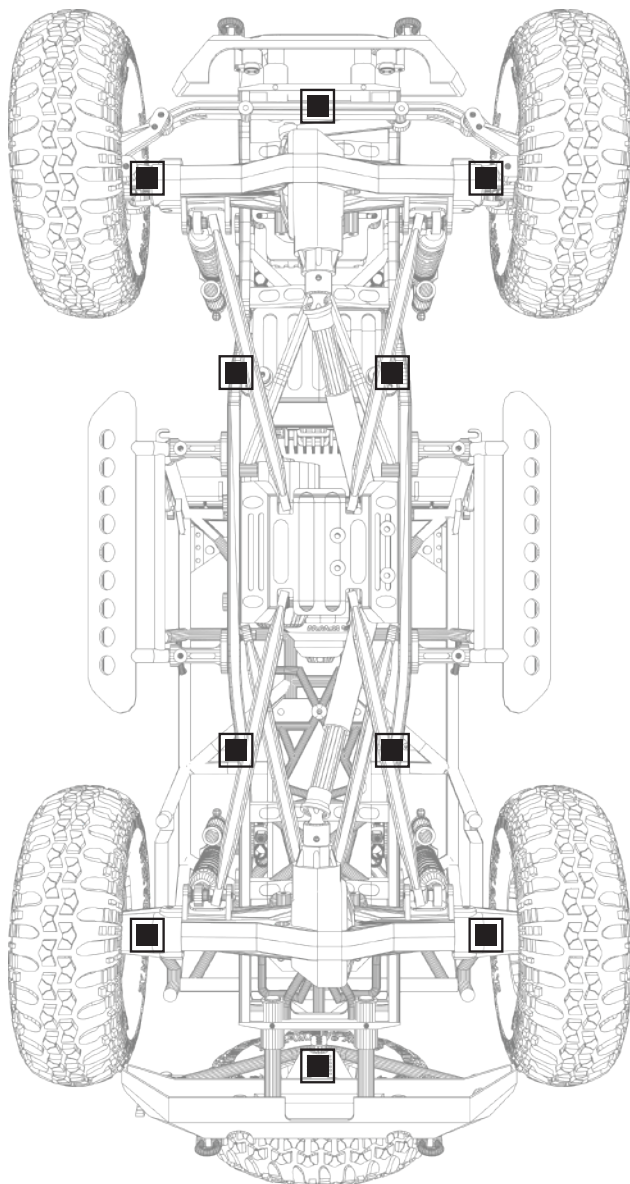

INSTALLATION STEPS

TOOLS REQUIRED

- 5/32-inch Drill Bit
- 7/64-inch Drill Bit
- Phillips Head Screwdriver

1. Designate your mounting locations for each Rock Light Pod and the control box. (Refer to page 2 for recommended mounting locations)

Avoid hot surfaces and/or moving parts.

2. Use a pen to mark the holes where you want to mount the Rock Light Pods. Then, drill a 5/32" hole(s) for the wire connector to pass through.
3. Drill a 7/64" hole for each marked hole.
4. Secure the Rock Light Pods using the included screws. (If mounting on a rounded or uneven surface, utilize the optional rubber mounting pads.)

Caution: Rock Light Pods become extremely hot during use - keep away from any vehicle parts that may be damaged by exposure to high temperatures.

5. Connect all Rock Light Pod wires to the control box connectors.

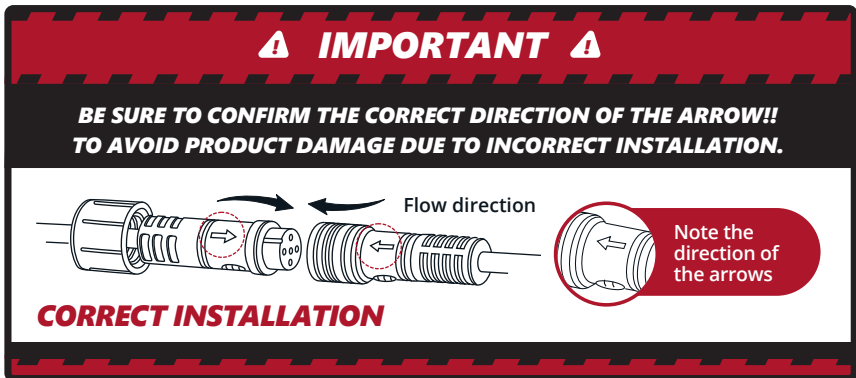

6. Connect the Red line(+) of power harness to the vehicle battery's positive terminal .
7. Connect the Black line (-) of power harness to the vehicle battery's negative terminal or an unpainted area on your vehicle's frame.

INSTALLATION STEPS

8. Open the OPT7 GLOW App, pair your smart device to the control box, and pair the remote control to pick your desired color!

QR CODE TO DOWNLOAD





Download the free "OPT7 GLOW" App

- App iOS (12+) available on App Store
- Android (8+) available on Google Play

Scan the QR code for the OPT7 GLOW user guide to experience all the features

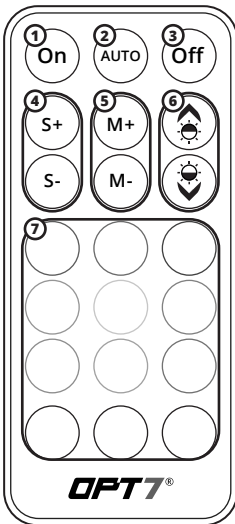

Using the included 21Key E-Z Remote, select your desired color or pattern.

- | | |
|---|---------------------------|
| 1 | Power-ON |
| 2 | Automatic Color Change |
| 3 | Power-OFF |
| 4 | Speed +/- 10 Levels |
| 5 | Mode +/- 24 Mode |
| 6 | Dimmer 10 Levels |
| 7 | Color Selection 12 Colors |

NOTE: When you use this product, keep it within 10m/33ft as much as possible.



Please ensure that the LED bars or strips/control box/wiring all are mounted in areas where will not exceed 85°C or 185°F.

HOW TO PAIR THE REMOTE

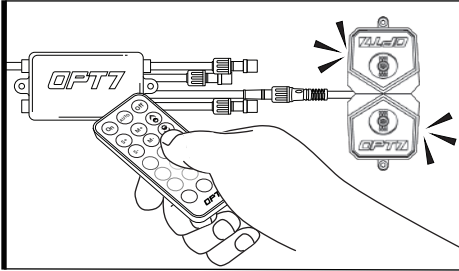

Pair the Device:

To pair the remote, reconnect the power, then aim the remote at the control box and hold the ON button until the LED strips flash white.

SPECIFICATIONS

Wattage	8W Per Pod
Amp Draw	8A
8 LEDs	Quad-Core CREE
Brightness	1,600 Lumens Per Pod
Voltage	12V
Resistance	IP68 Water-Resistant (Pod Only)
Operating Temperature	-20°-150°F

DISCLAIMER

OPT7 Lighting is not liable for damages or personal injuries while installing this product. The Installation Guide is intended as assistance to reduce setup time.

OPT7 Lighting assumes no responsibility for improper installation. If you are unfamiliar with your vehicle or inexperienced with aftermarket upgrades, please seek professional assistance.

OPT7 recommends installation for safety and guidance.

Modified installations or installation recommendations not specified by OPT7 Lighting will void product warranty.



Follow us on **Instagram**
@opt7lighting



Subscribe to our **YouTube** channel.
Opt7Lighting