

OPT7 PLUS

OPT7 PLUS APPLICATION USER GUIDE

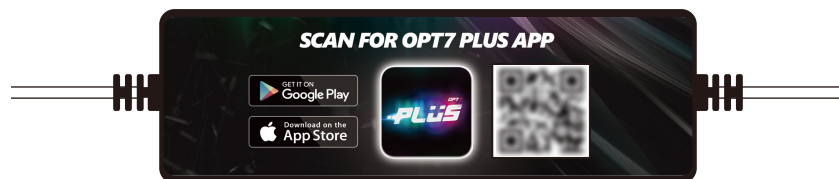
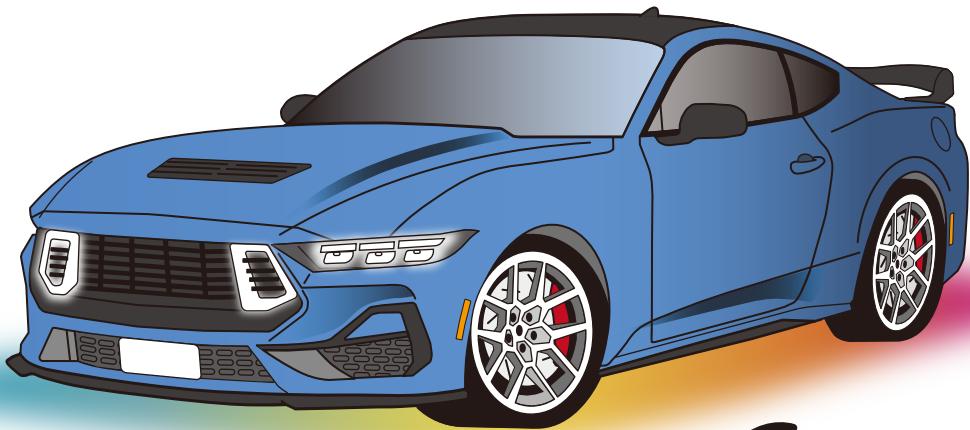

NOTICE

Please scan the QR code on the side of the control box and download the OPT7 PLUS App for the best experience.

CONTENTS

How To Connect & Disconnect	2
System Settings	4
Device Settings	5
RGB Mode	8
Rhythm Mode	9
Light Mode	12
Pixel Setting	13
Color Setting	15

NOTICE

OPT7 PLUS supports the car media system with Bluetooth and Android Auto, but does not support Apple CarPlay.

HOW TO CONNECT

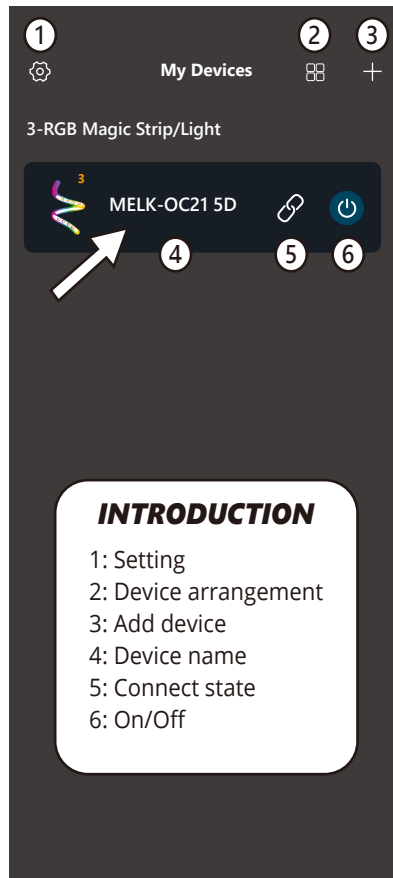
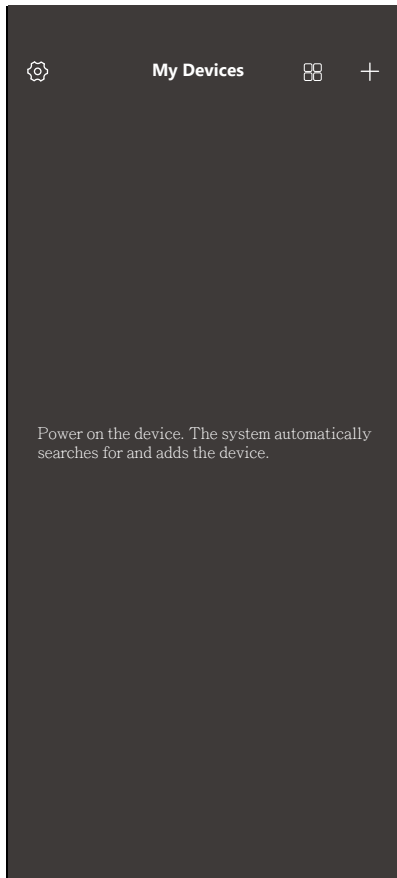

STEP 1

Install the OPT7 light kit, then launch the OPT7 PLUS App and ensure Bluetooth is turned on.

STEP 2

The App will automatically detect your OPT7 light kit. Tap the device to enter light control mode.

NOTICE

If the OPT7 PLUS shows the icon , which means the device is not connected. Please click this icon again or check if the Bluetooth and the OPT7 light kit work normally.

IMPORTANT

- *On Android, please enable the "Nearby devices" permission to allow searching for devices.
- *OPT7 PLUS App can connect up to 4 OPT7 PLUS control boxes.
- *If there is no device on the list, please check "Auto Add Devices" in System Settings instruction on page 4.

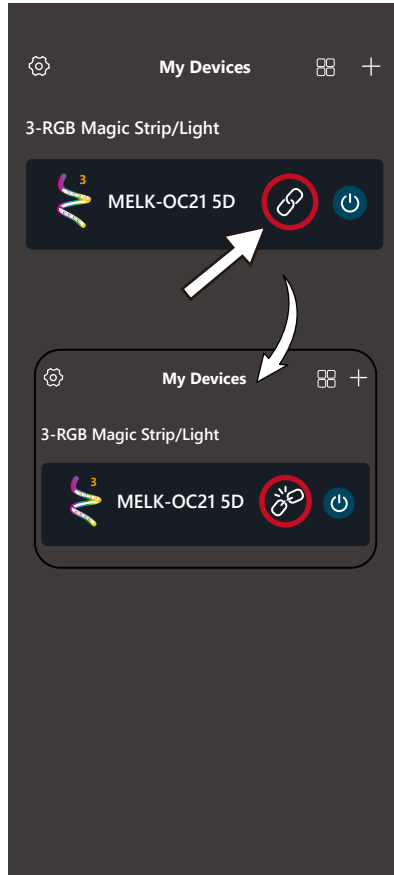
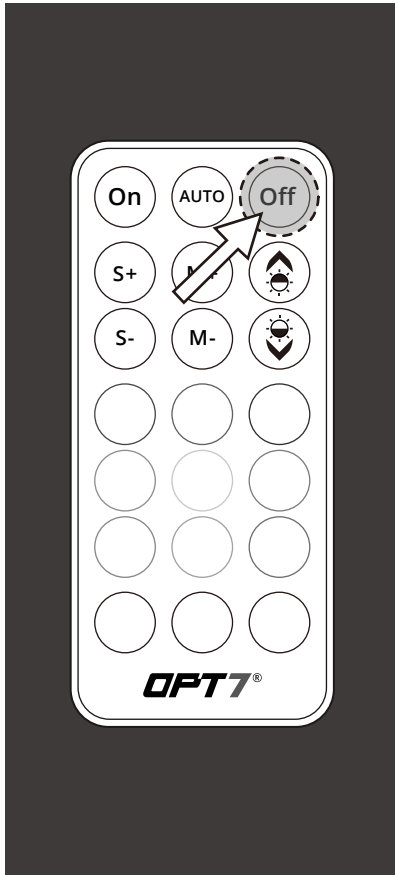

HOW TO DISCONNECT



STEP 1

Use the remote control to disconnect the OPT7 light kits.
*Need to align the control box.

STEP 2

To disconnect the OPT7 light kits. Click the icon  to .

STEP 3

Ensure the OPT7 light kits are turned off using the remote control. Then, disconnect the OPT7 PLUS and slide the App out to power it off.

IMPORTANT

*Turning off the OPT7 PLUS completely avoids excessive battery consumption and extends the lifespan of the OPT7 light kits.

SYSTEM SETTINGS

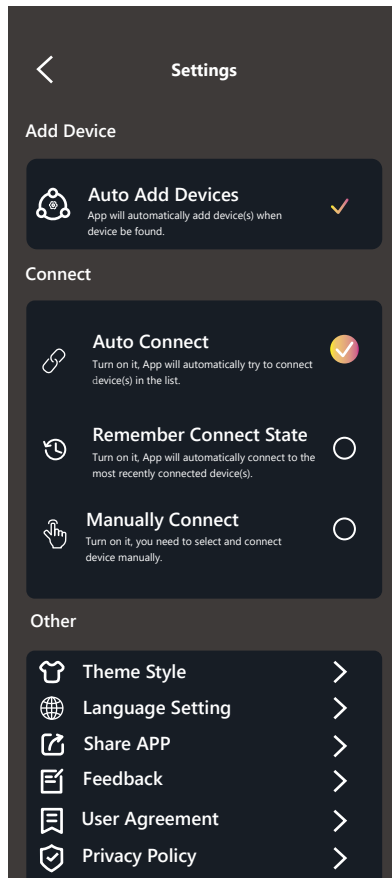
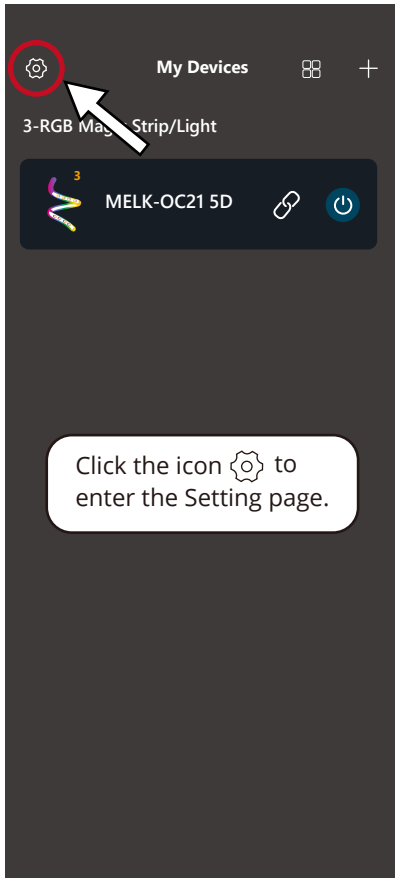

INTRODUCTION 1
OPT7 PLUS will detect the OPT7 light kits automatically.
*Recommended to enable the function

INTRODUCTION 2
Auto Connect:
OPT7 PLUS will connect all devices on the list.
Remember Connect State
OPT7 PLUS will remember the last connected device(s) and light mode.
Manually Connect
OPT7 PLUS will not connect any devices until choosing one.

INTRODUCTION 3
Other settings:
Customized settings, including Theme Style, Language, Share App, Feedback, User Agreement, and Privacy Policy.

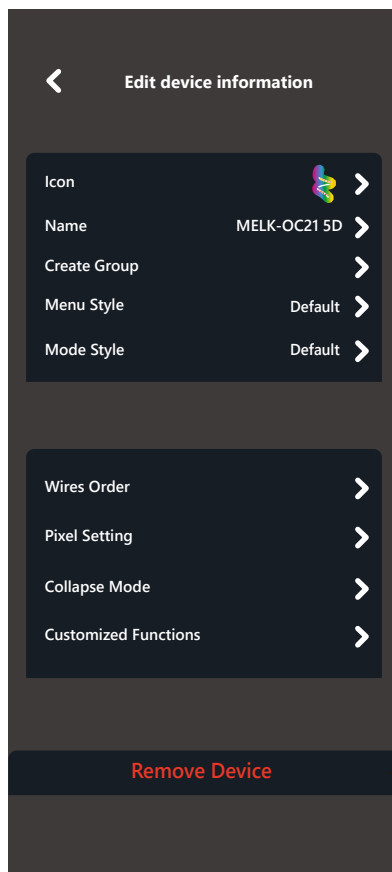
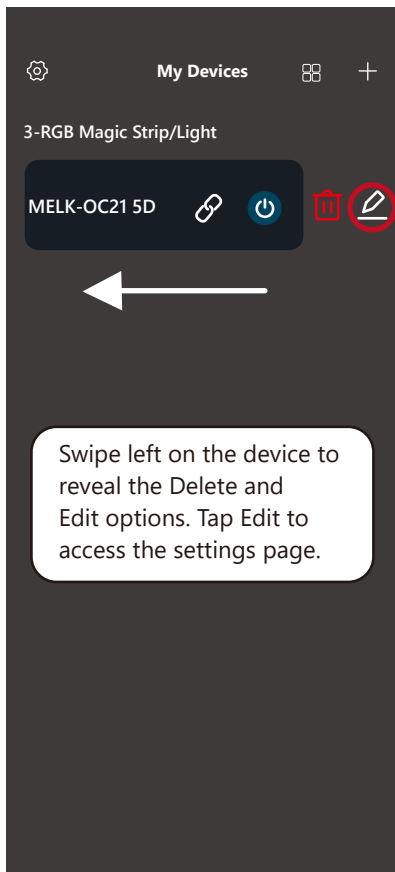

INTRODUCTION

- 1: Icon setting
- 2: Name setting
- 3: Group setting
- 4: Menu Style setting (Default/Tab Bar/Beehive)
- 5: Light Mode Style (Default/GIF/Text)
- 6: Wires Order Setting (Adjust RGB order)
- 7: Pixel Setting (Not support)
- 8: Collapse Mode (Not support)
- 9: Customized Functions (Not support)
- 10: Remove Device (Clear and forget the device)

DEVICE RENAME

How To Rename the Devices and Create a Group

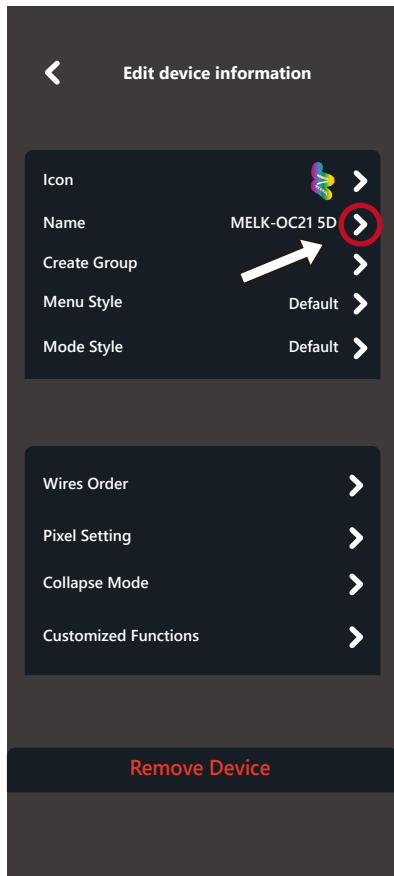

Tap the arrow to open the pop-up dialog, then rename your device.

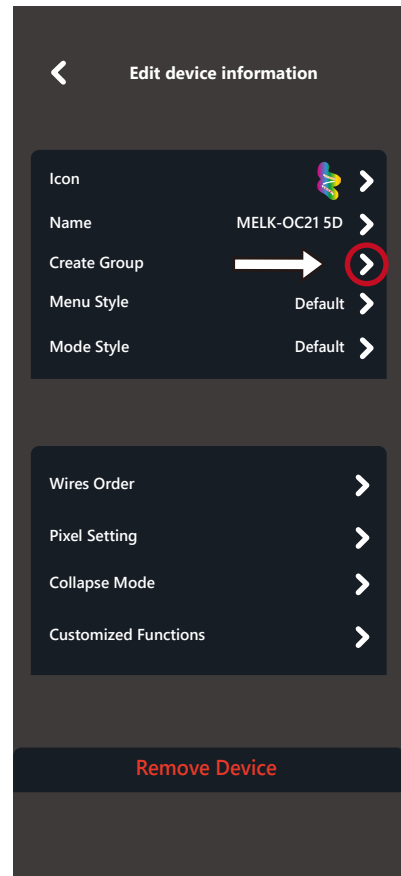

Tap the arrow to open the Add Group page.

DEVICE SETTING

How To Rename the Devices and Create a Group

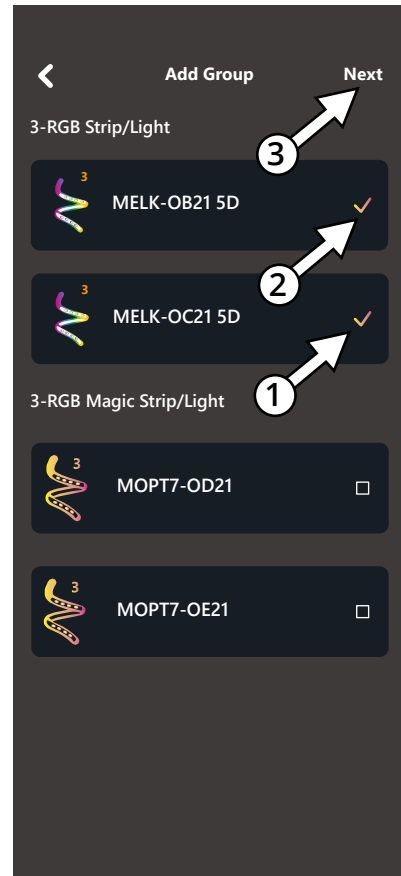

*Grouping is only supported between identical LED types: RGB to RGB, or RGB Magic (DreamColor) to RGB Magic.

*Different LED types cannot be grouped or controlled together.

*Grouping Restriction: Only identical LED types can be grouped together.

*App Limit: A maximum of 4 kits can be connected to a single App.

*Operation: Select the same LED type as indicated by arrows 1 and 2, then tap Next.

DEVICE SETTING

How To Rename the Devices and Create a Group

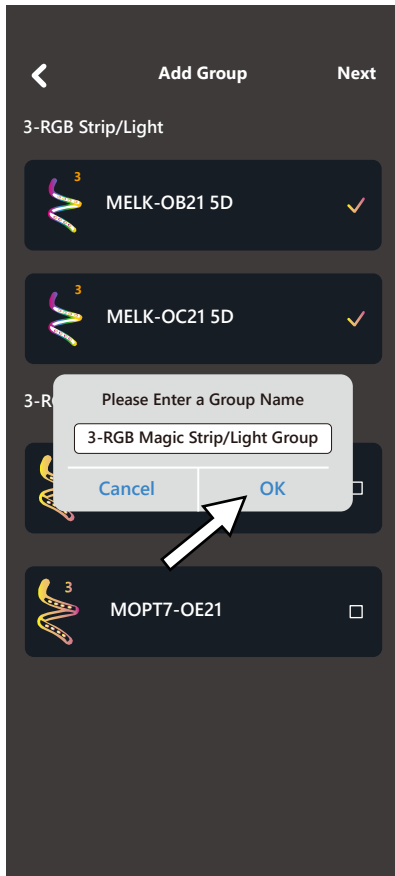

Enter your desired group name (for example, "Magic Strip/Light" for DreamColor kits). Once named, tap OK to complete the setup.

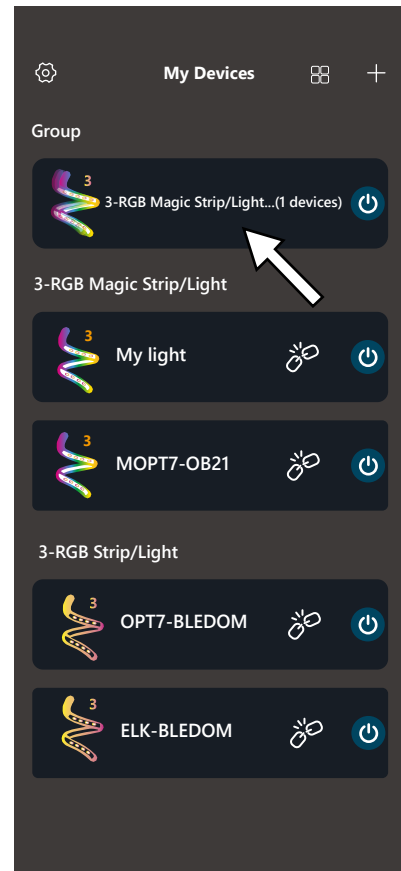

The App can now control the grouped LED kits simultaneously. Please note that color modes or display effects may vary across certain kits due to differences in strip length.

RGB MODE



USER INTERFACE

INTRODUCTION

- 1: Device name
- 2: Device setting
- 3: On/Off
- 4: RGB mode
- 5: Rhythm mode
- 6: Light mode
- 7: Scenes mode
- 8: More information

RGB MODE

INTRODUCTION

- 1: Touch to choose color
- 2: Shortcut color (6 color)
- 3: Favorite color (4 color) (click ⊕ then choose a color to create a shortcut; press the shortcut to delete)
- 4: Brightness adjust (0-100)



RHYTHM MODE

RHYTHM MODE-DEVICE MIC

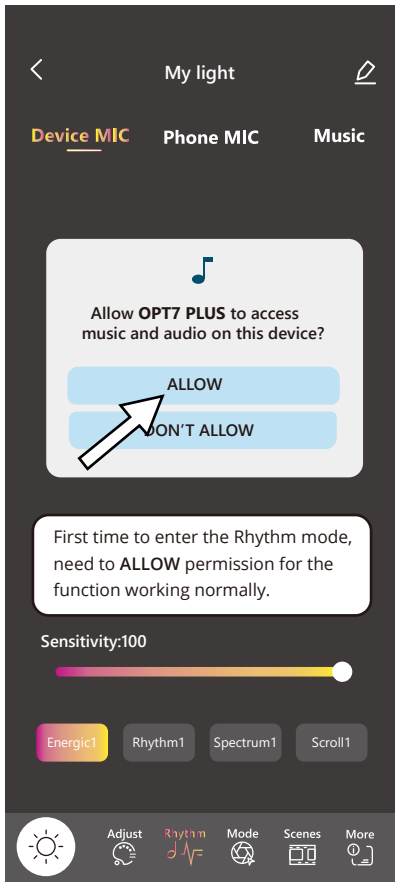

INTRODUCTION

- 1: Cell phone MIC is receiving (Not supported by all devices)
- 2: Device name
- 3: Device setting
- 4: Device MIC (use OPT7 control box to receive)



- 5: Phone MIC (use the cell phone to receive)
- 6: Music MIC (use the cell phone music)
- 7: Sound wave (changes with the audio)
- 8: Radio sensitivity adjust (0-100)
- 9: Light effect (4 modes)

*Not all OPT7 light Kits support the Device MIC function.

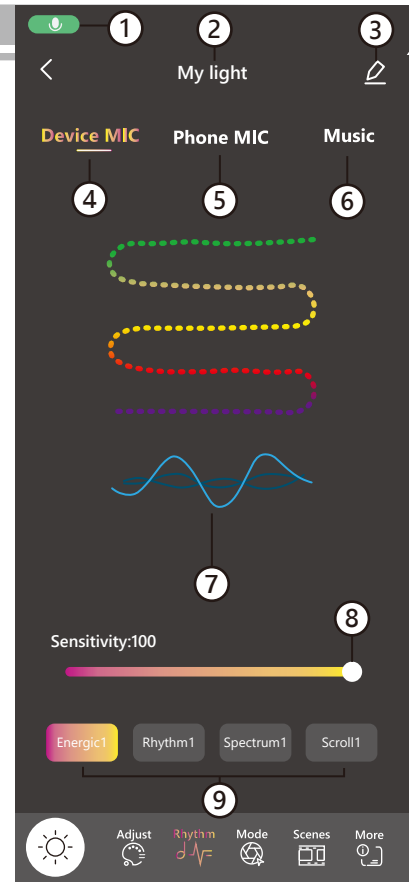

RHYTHM MODE-PHONE MIC

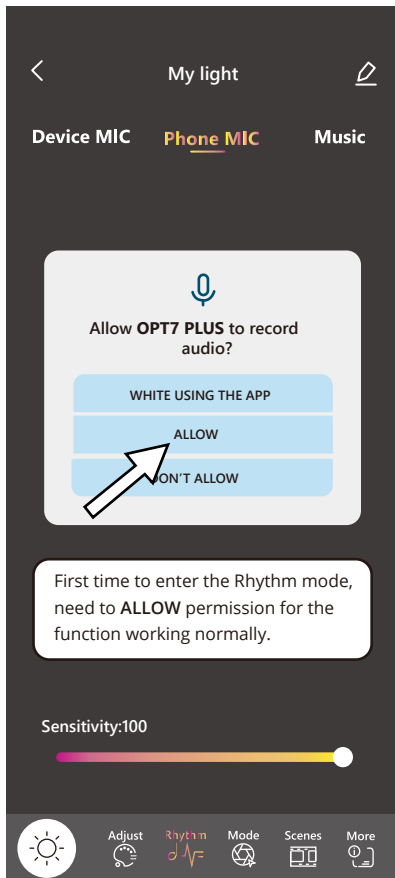

INTRODUCTION

- 1: Cell phone MIC is receiving (Not supported by all devices)
- 2: Device name
- 3: Device setting
- 4: Device MIC (use OPT7 control box to receive)
- 5: Phone MIC (use the cell phone to receive)
- 6: Music MIC (use the cell phone music)
- 7: Sound wave (changes with the audio)
- 8: Radio sensitivity adjust

IMPORTANT

- *The Phone MIC supports Android Auto only.
- *When using the Phone MIC, users must enable the background permissions.
- *Phone MIC supports only a device or a group at once.

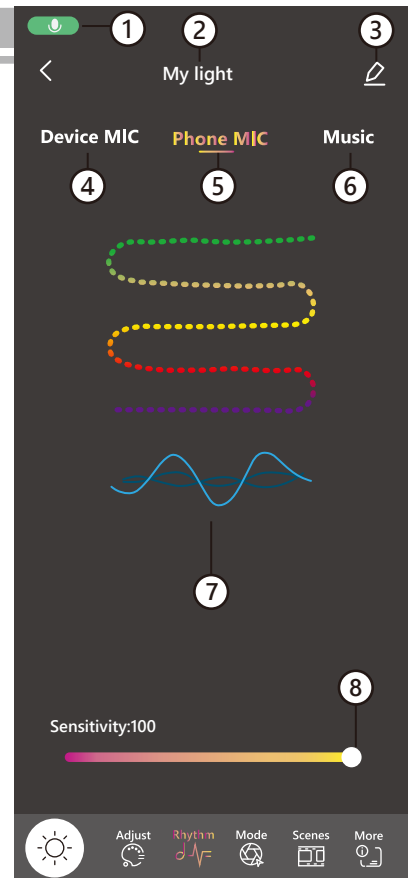

RHYTHM MODE

RHYTHM MODE-MUSIC MIC

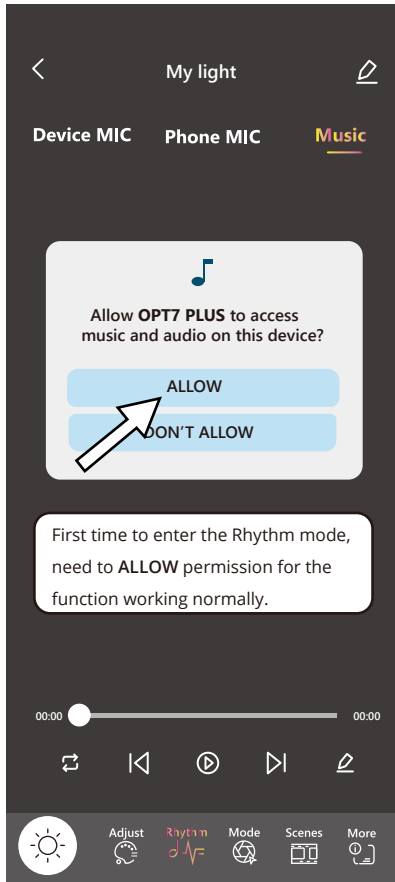

INTRODUCTION

- 1: Playlist (9 built-in songs)
- 2: Media player
- 3: Edit the playlist

HOW TO USE PHONE MUSIC

ANDROID

The music files on the phone will be imported into the playlist automatically.

iOS

Need to connect to iTunes on a computer to download the music file to the iPhone.

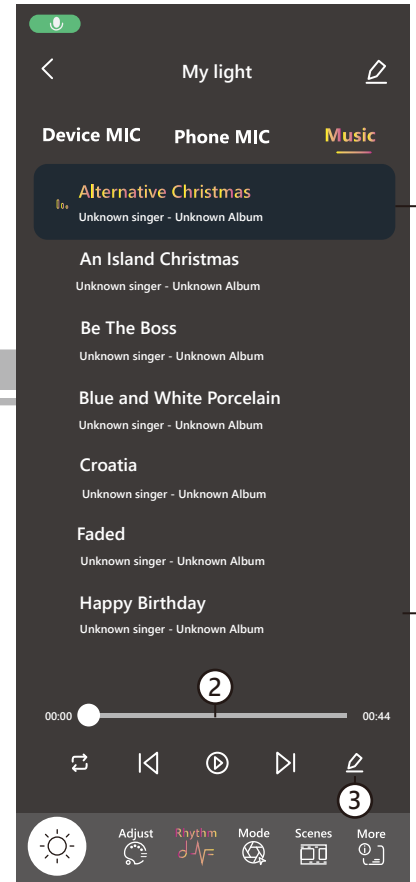

ANDROID SYSTEM

BACKGROUND PLAYING

The Phone MIC in the App allows music to play in the background while users are using other Apps.

ANDROID SYSTEM

SPLIT SCREEN

The OPT7 PLUS supports the split screen function so keep both the music App and the OPT7 PLUS on the screen, the function will work.

IMPORTANT

- *The Phone MIC supports Android Auto only.
- *When using the Phone MIC, users must enable the background permissions.
- *Not all mobile devices support the split screen function.
- *Music supports only a device or a group at once.

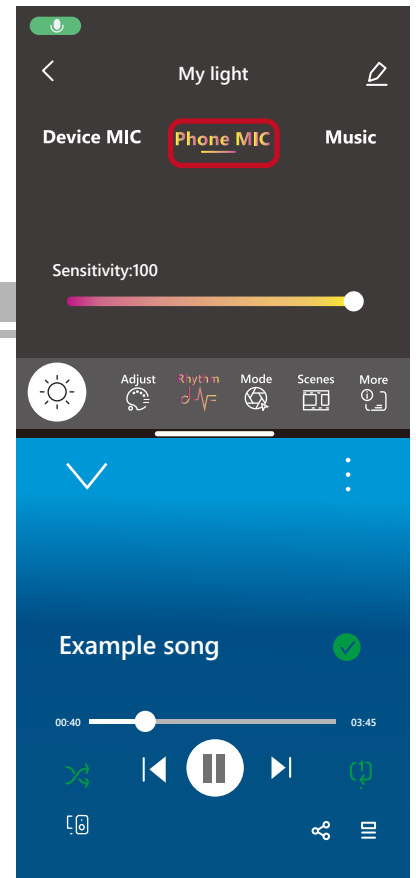

RHYTHM MODE

iOS SYSTEM

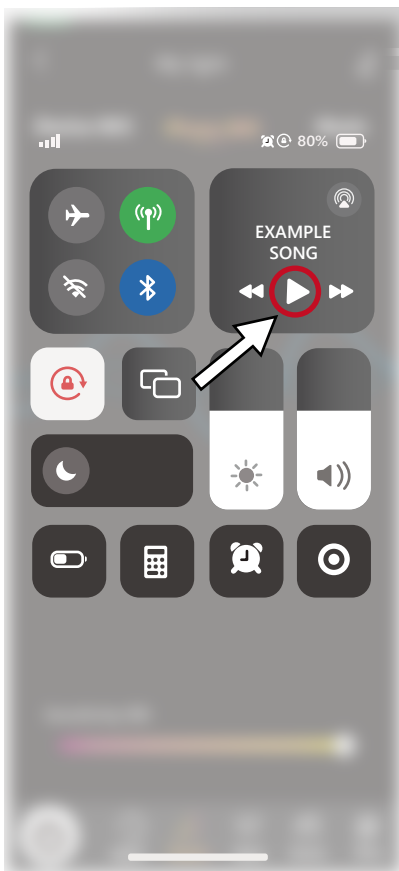

BACKGROUND PLAYING

The Phone MIC in the App allows music to play in the background while users are using other Apps.

IMPORTANT

*The Phone MIC does not support Apple CarPlay.

*When using the Phone MIC, users must enable the background permissions.

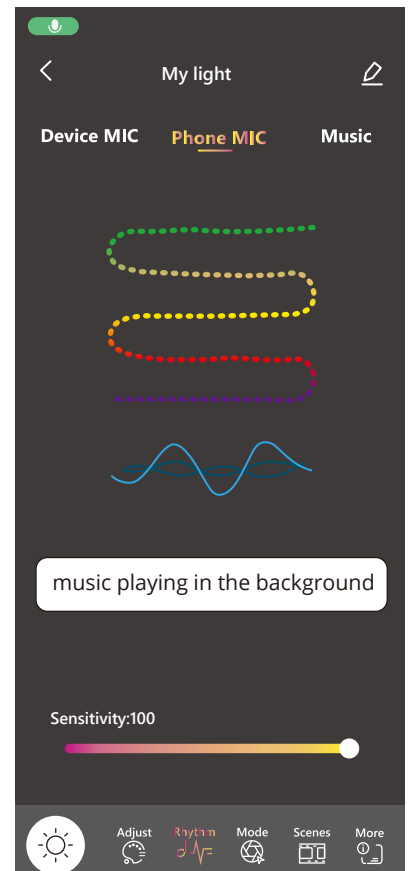

LIGHT MODE

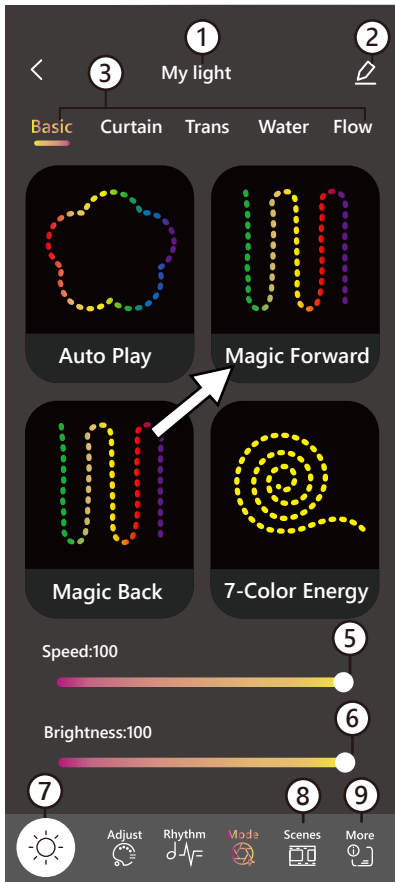

LIGHT MODE

INTRODUCTION

- 1: Device name
- 2: Device setting
- 3: Light mode catalog
- 4: Light mode with animation (touch one to set)
- 5: Speed
- 6: Brightness
- 7: On/Off
- 8: Scenes mode
- 9: More information

SCENES MODE

INTRODUCTION

- 1: Device name
- 2: Device setting
- 3: Scenes (add is not supported)
- 4: On/Off
- 5: More information

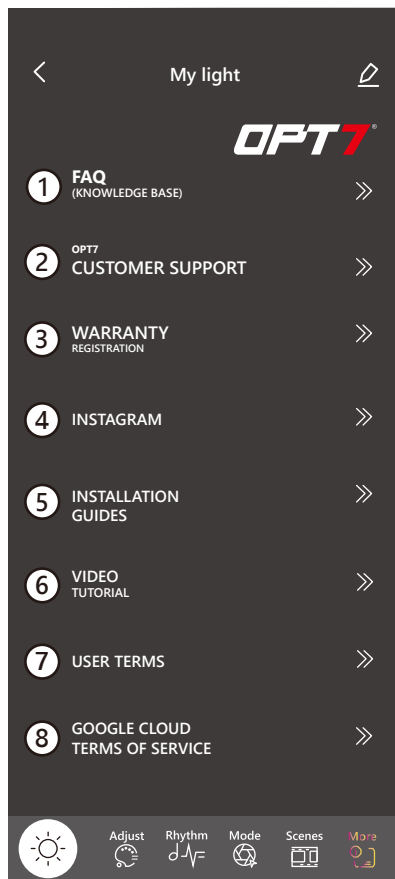
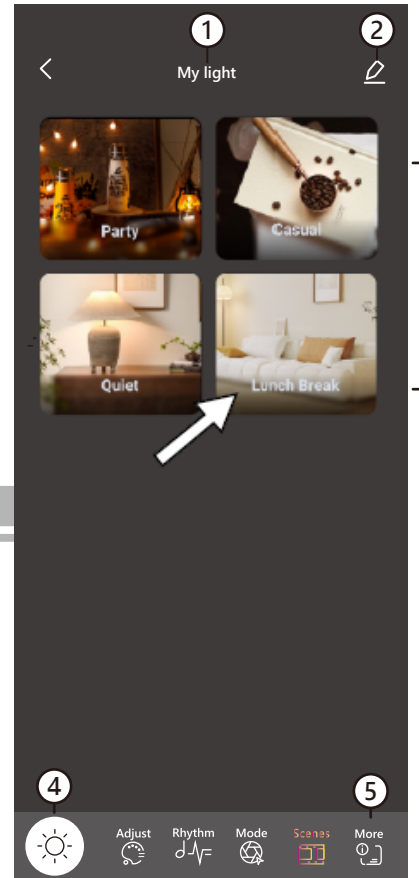

MORE INFORMATION

INTRODUCTION

1: FAQ (KNOWLEDGE BASE)

Access our Knowledge Base for comprehensive guides and instructional videos to support your installation requirements effectively.

2: OPT7 CUSTOMER SUPPORT

OPT7 offers comprehensive customer support, including assistance with your questions, technical issues, and App functionality.

3: WARRANTY REGISTRATION

Learn how to file a warranty claim and register your product for warranty.

4: SOCIAL MEDIA

Stay updated with OPT7 on social media for new tips, tricks, giveaways, and the latest information for auto enthusiasts.

5: INSTALLATION GUIDES:

Explore our install guides for a seamless experience.

6: VIDEO TUTORIAL

Subscribe to the OPT7 YouTube Channel for installation tutorials, product highlights, and more.

7: USER TERMS

Learn about our privacy policy and find out what information we collect when placing an order.

8: GOOGLE CLOUD TERMS OF SERVICE

HOW TO SET PIXEL

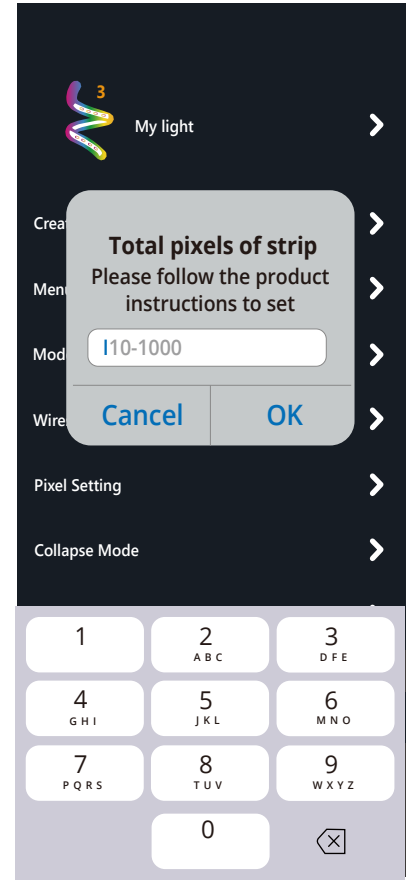
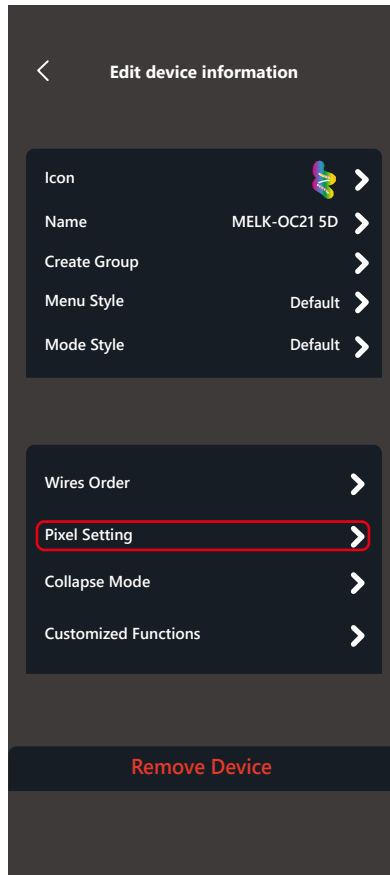

STEP 1

Ensure that the control box is properly connected then Click the icon  to enter Product Settings.

STEP 2

Click Pixel Setting to access the configuration.

STEP 3

Refer to the table below for the corresponding pixel values of the OPT7 product. Enter the correct values to ensure proper functionality.

IMPORTANT

- *Verify that the control box is correctly set up and connected to the App when setting the control box pixel.
- *Only Dreamcolor products require pixel adjustments.
- *Make sure to enter the correct pixel values corresponding to your product.
- *Incorrect values may cause the product to malfunction.
- *After setting the pixel, remember to pair the remote control.

OPT7 PLUS DREAMCOLOR SERIES

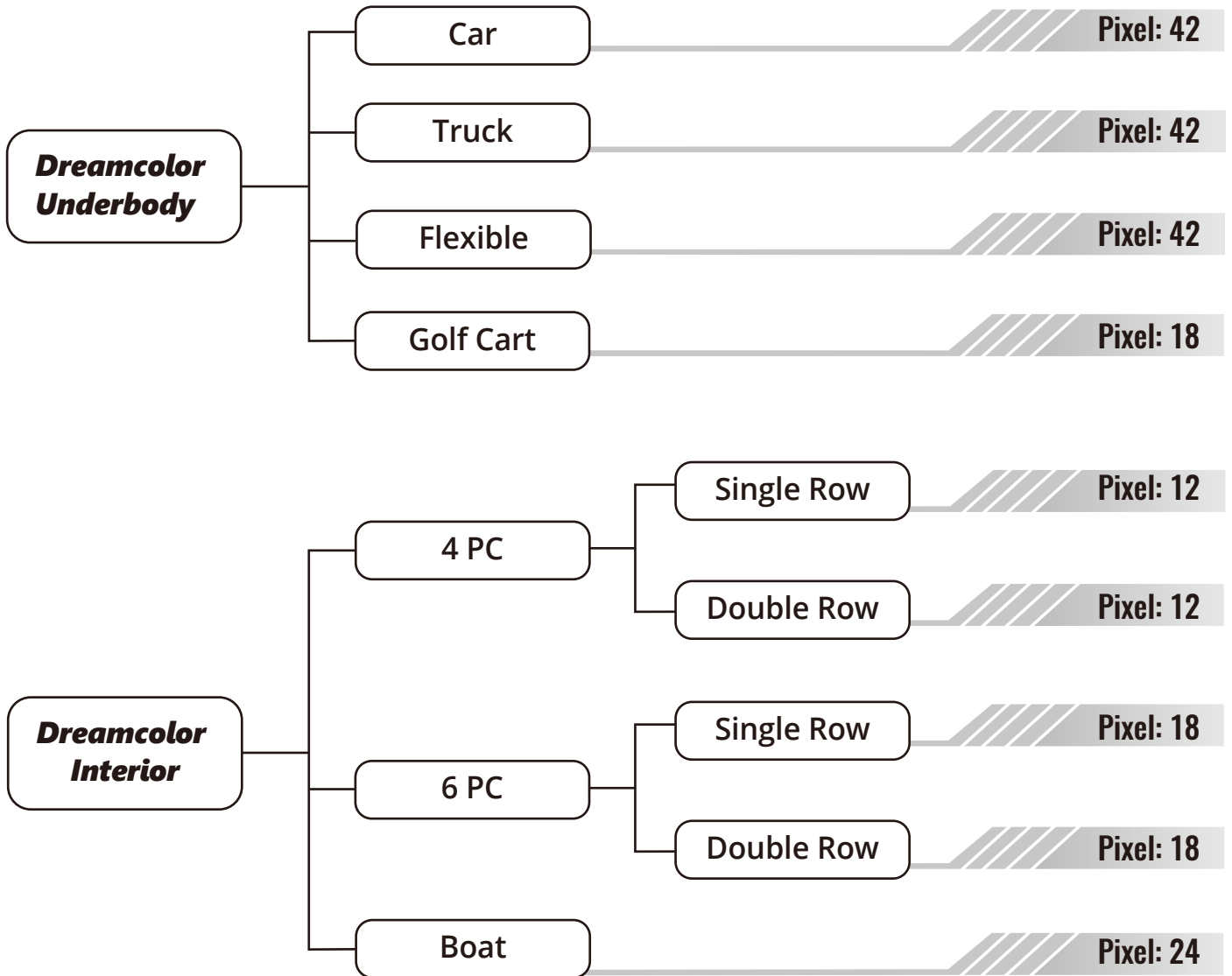

COLOR SETTING

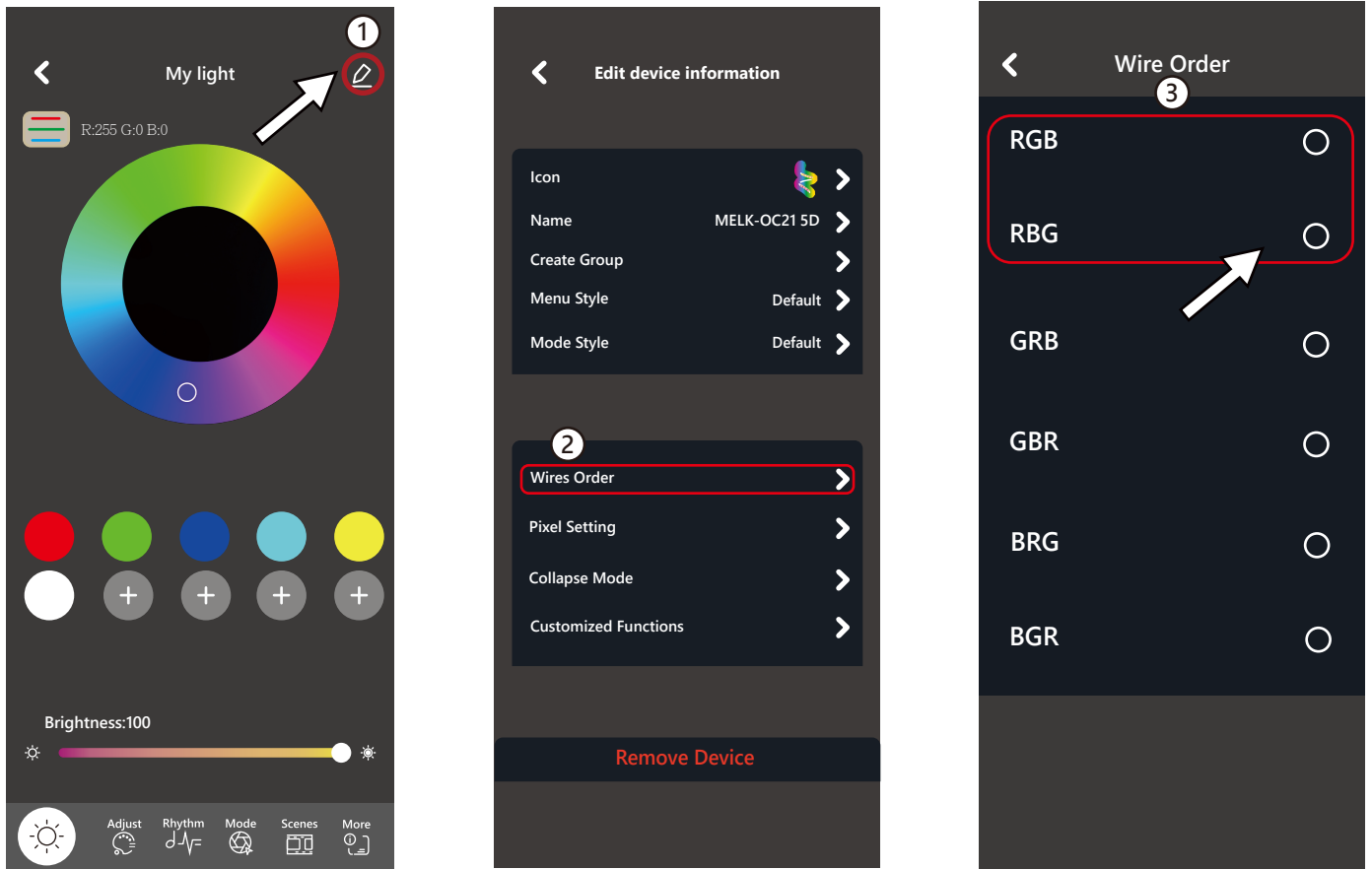

If you are having issues with color discrepancy between what's selected in the app and what the light kit actually displays. Here's a detail breakdown to remedy the issue.

STEPS

1. Open Setting

Navigate to the PENCIL Icon located in the upper right corner of the screen.

2. Access Wire Order setting

In the settings, locate and select the option labeled Wires Order.

3. Select the RGB as the Color Option

Choose RGB as the color section. If selecting **RGB** results in incorrect colors, please switch to **RBG**.

***If the issue persists, please contact the OPT7 Support Team:**

<https://www.opt-7.com/pages/customer-support>

DISCLAIMER

OPT7 Lighting is not liable for damages or personal injuries while installing this product. The Installation Guide is intended as assistance to reduce setup time. OPT7 Lighting assumes no responsibility for improper installation. If you are unfamiliar with your vehicle or inexperienced with aftermarket upgrades, please seek professional assistance.

OPT7 recommends installation for safety and guidance. Modified installations or installation recommendations not specified by OPT7 Lighting will void product warranty.