

# OPT7 GLOW

## OPT7 GLOW APPLICATION USER GUIDE

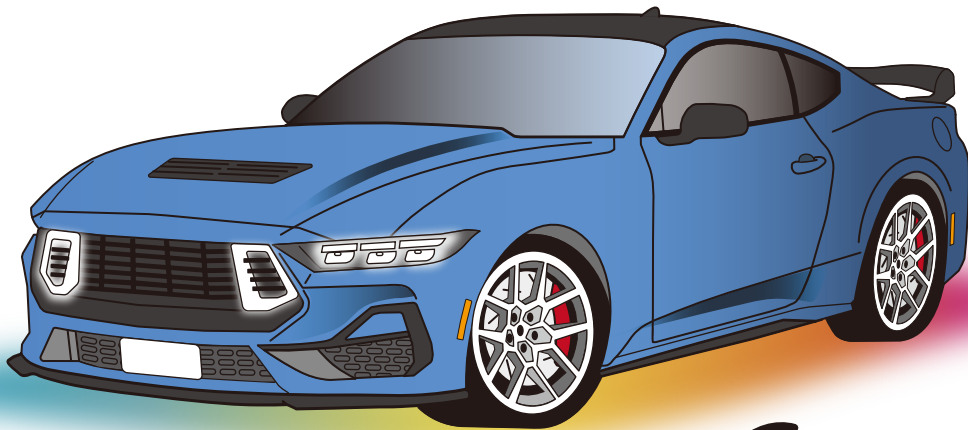

### QR CODE TO DOWNLOAD

GET IT ON  
Google Play

Download on the  
App Store



SCAN FOR APP

OPT7®  
GLOW



- Download the free "OPT7 GLOW" App
- App iOS (12+) available on App Store
  - Android (8+) available on Google Play

# CONTENTS

How To Connect & Disconnect	2
System Settings	4
Device Settings	5
RGB Mode	6
Rhythm Mode	7
Light Mode	9

**NOTICE**

OPT7 GLOW supports the car media system with Bluetooth and Android Auto, but does not support Apple Carplay.

# HOW TO CONNECT

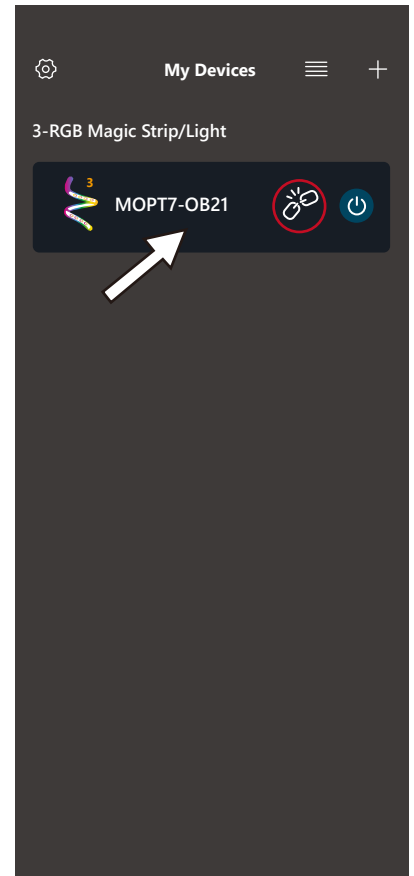
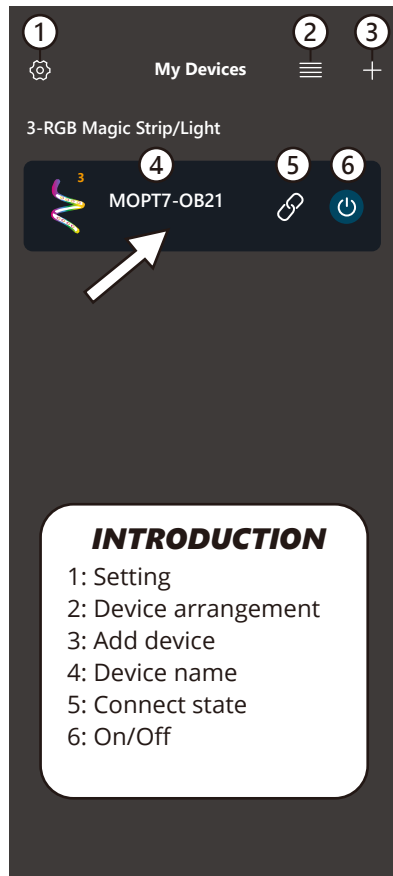
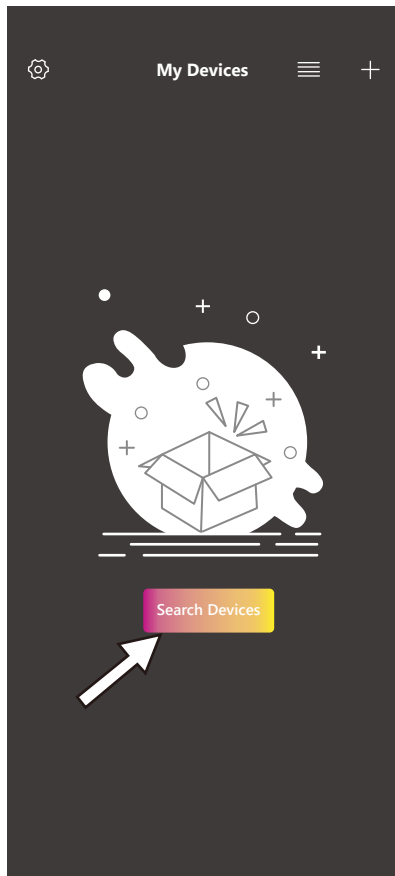

## STEP 1

First view the OPT7 GLOW. After installing the OPT7 light Kits, open the OPT7 GLOW and keep the Bluetooth open then click "Search Devices" to connect.

## STEP 2

OPT7 GLOW will detect OPT7 light Kits automatically. Click the device into the light control mode.

## NOTICE

If the OPT7 GLOW shows the icon , which means the device is not connected. Please click this icon again or check if the Bluetooth and the OPT7 light kits work normally.

## IMPORTANT

- \*On the Android system, it needs to allow the Nearby Devices Permission to search the devices.
- \*OPT7 GLOW connects a maximum of 4 devices.
- \*If there is no device on the list, please check the Auto Add Devices. (See more system settings on the page 3.)

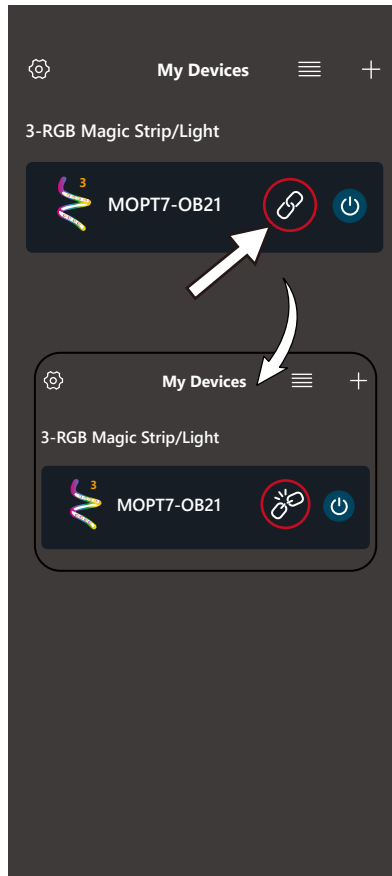
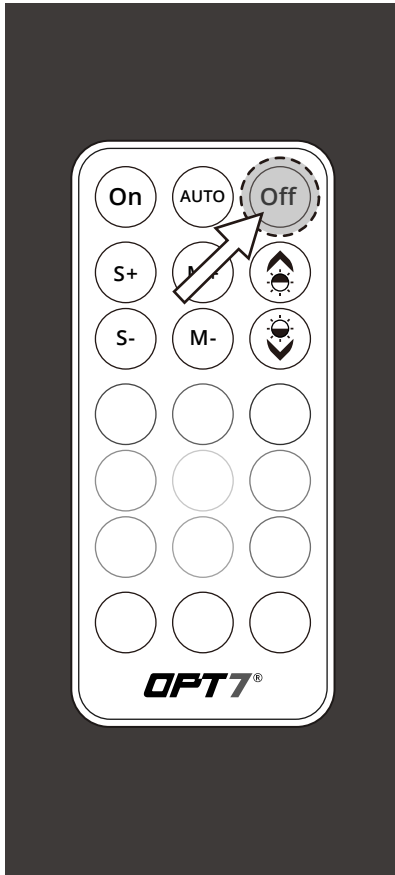

# HOW TO DISCONNECT



## STEP 1

Use the remote control to disconnect the OPT7 light kits.  
\*need to align the control box

## STEP 2

To disconnect the OPT7 light kits. Click the icon  to .

## STEP 3

Ensure the OPT7 light kits are turned off using the remote control. Then, disconnect the OPT7 GLOW and slide the App out to power it off.

## IMPORTANT

\*Turning off the OPT7 GLOW completely helps avoid excessive battery consumption and extends the lifespan of the OPT7 light kits.

# SYSTEM SETTINGS

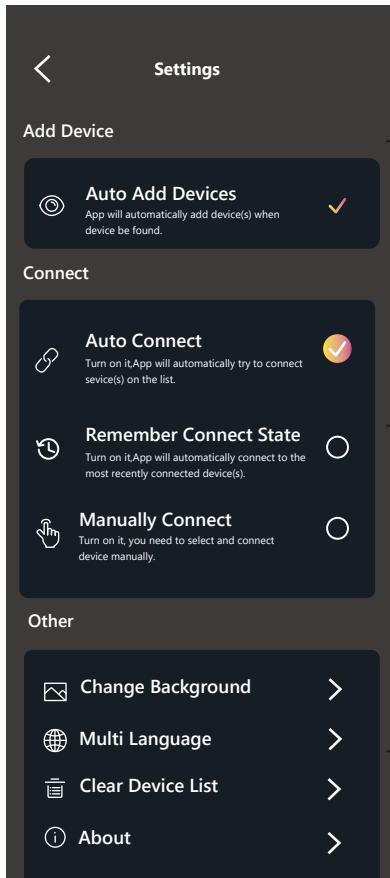
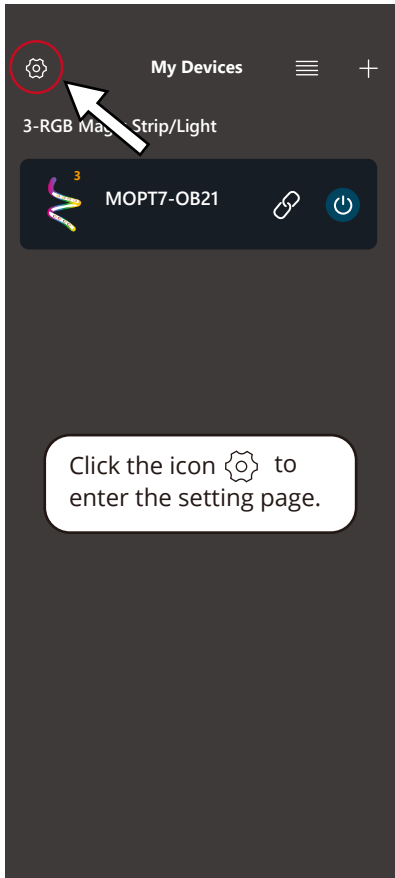

**INTRODUCTION 1**  
OPT7 GLOW will detect the OPT7 light kits automatically.  
\*Recommended to enable the function

**INTRODUCTION 2**  
**Auto Add Devices:**  
OPT7 GLOW will connect all devices on the list.  
**Remember Connect State**  
OPT7 GLOW will remember the last connected device(s) and light mode.  
**Manually Connect**  
OPT7 GLOW will not connect any devices until choosing one.

**INTRODUCTION 3**  
**Other settings:**  
Customized settings, including background, language, and clear device list.

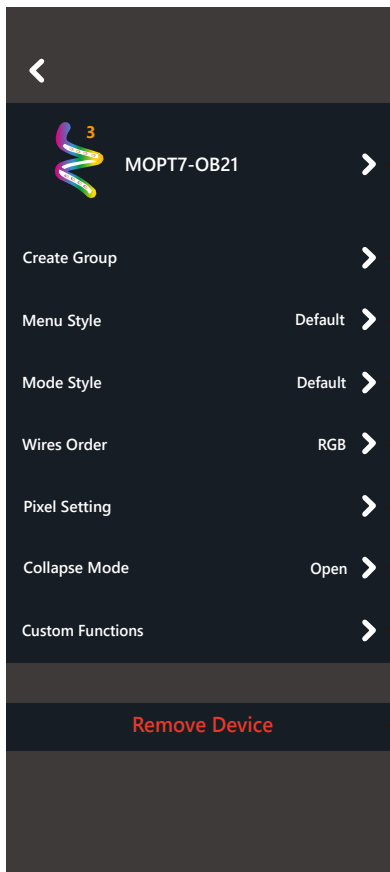
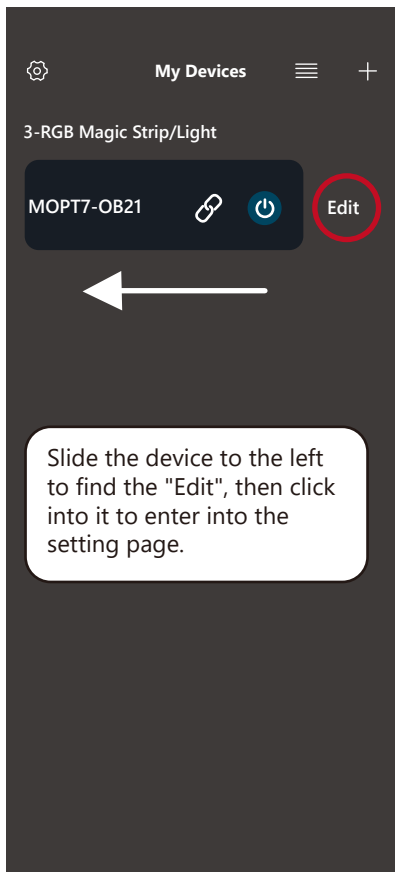

**INTRODUCTION**

- 1: Device setting (Icon /name)
- 2: Group setting
- 3: Menu Style setting (Default/Tab Bar/Beehive)
- 4: Light Mode Style (Default/GIF/Text)
- 5: Wire Setting (Adjust RGB order)
- 6: Pixel Setting (Not support)
- 7: Collapse Mode (Not support)
- 8: Custom Functions (Not support)
- 9: Remove Device (Clear and forget the device)

# DEVICE SETTING

## How To Rename the Devices and Create a Group

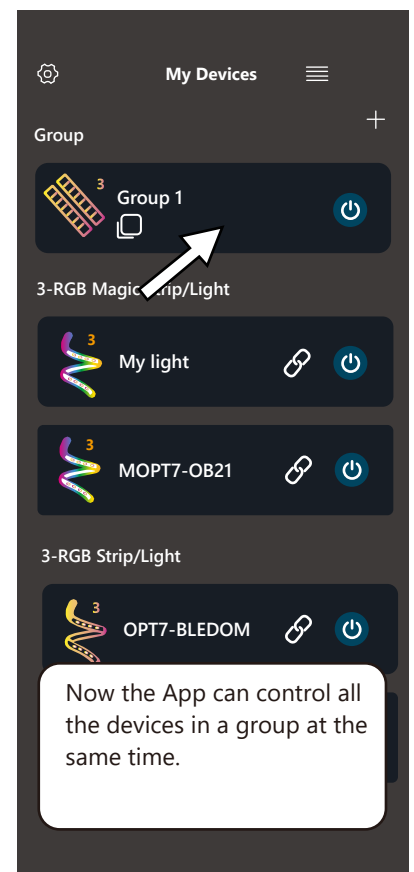
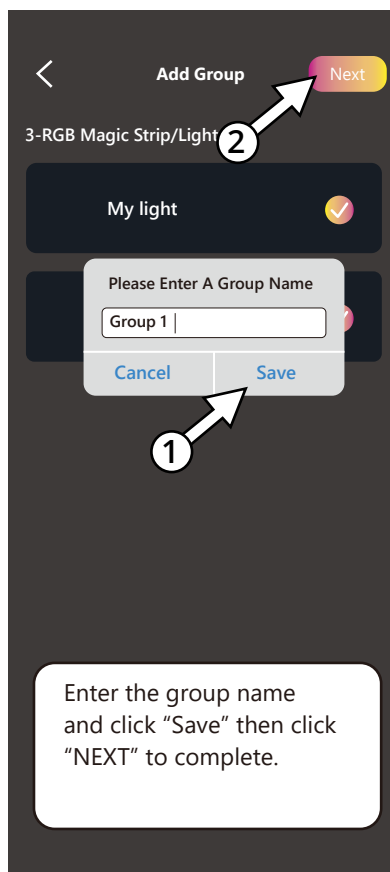
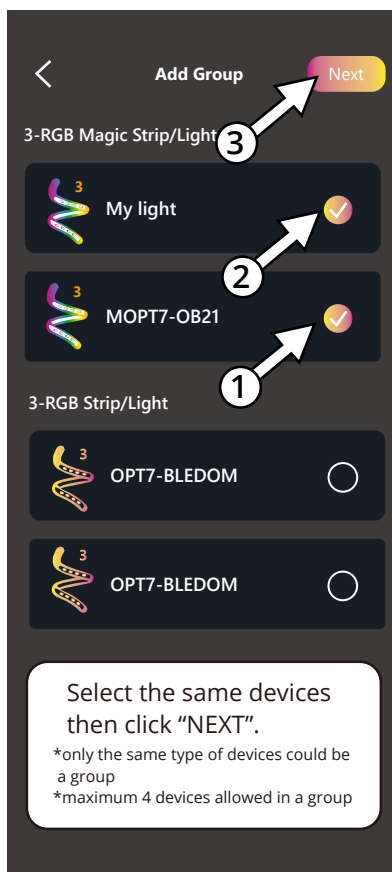
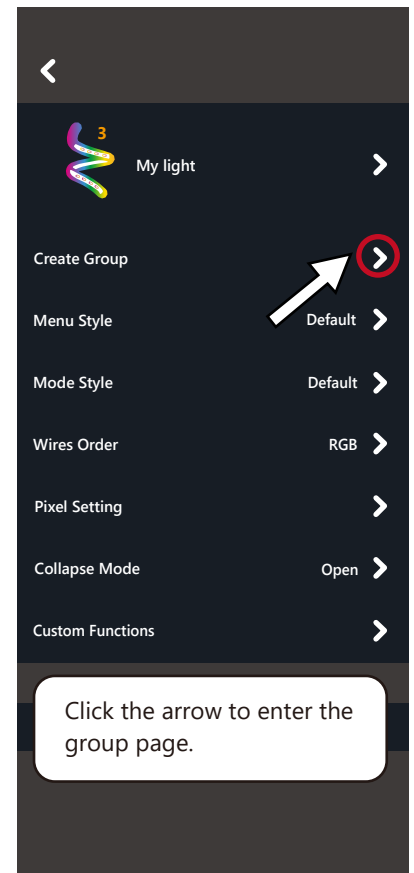
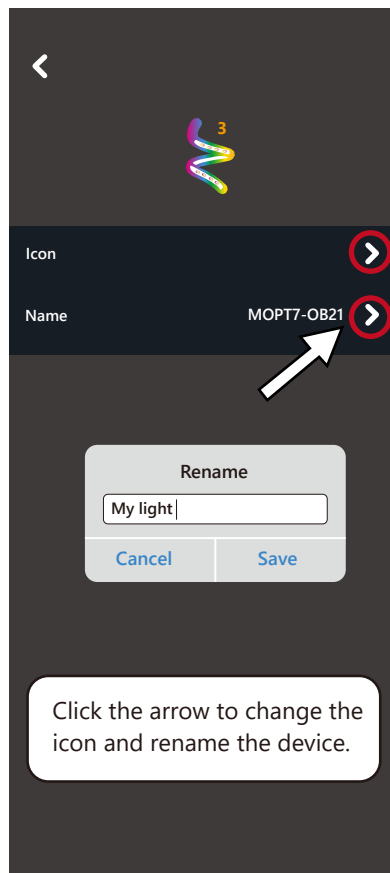
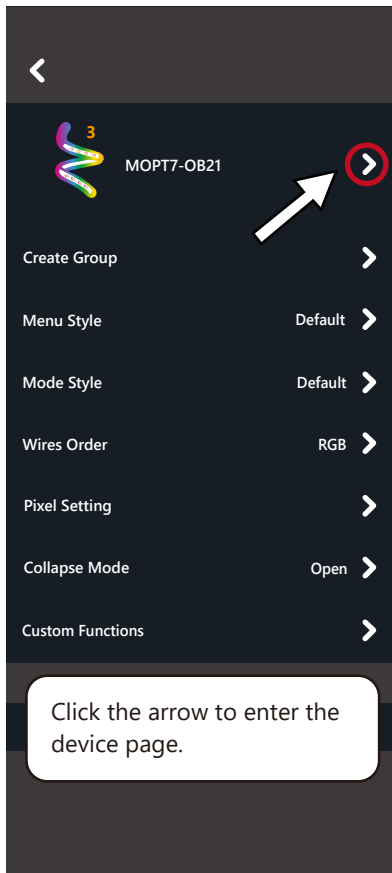

# RGB MODE



## USER INTERFACE

### INTRODUCTION

- 1: Device name
- 2: Device setting
- 3: On/Off
- 4: RGB mode
- 5: Rhythm mode
- 6: Light mode
- 7: Scenes mode
- 8: More information

## RGB MODE

### INTRODUCTION

- 1: Touch to choose color
- 2: Shortcut color (6 color)
- 3: Favorite color (4 color) (click ⊕ then choose a color to create a shortcut; press the shortcut to delete)
- 4: Brightness adjust (0-100)

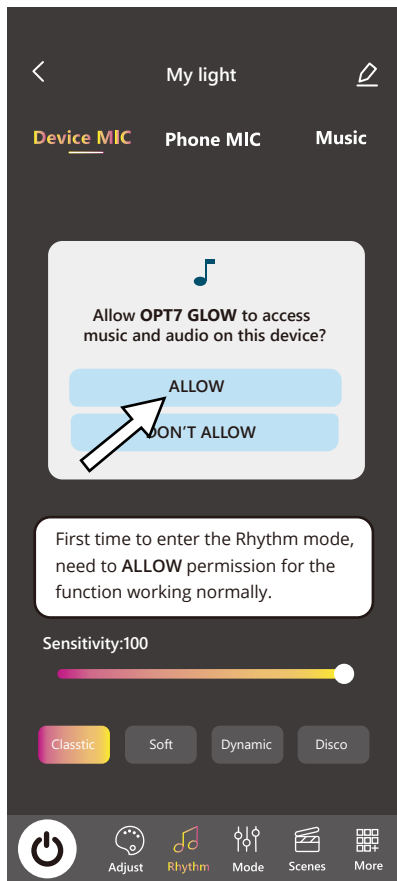

## RHYTHM MODE-DEVICE MIC

### INTRODUCTION

- 1: Cellphone MIC is receiving (Not all cellphone support)
- 2: Device name
- 3: Device setting
- 4: Device MIC (use the control box of the OPT7 light kits to receive)



- 5: Phone MIC (use the cellphone to receive)
- 6: Music MIC (use the cellphone music)
- 7: Sound wave (changes with the audio)
- 8: Record sensitivity adjust (0-100)
- 9: Light effect (4 modes)

\*Not all OPT7 light Kits support the device MIC function.

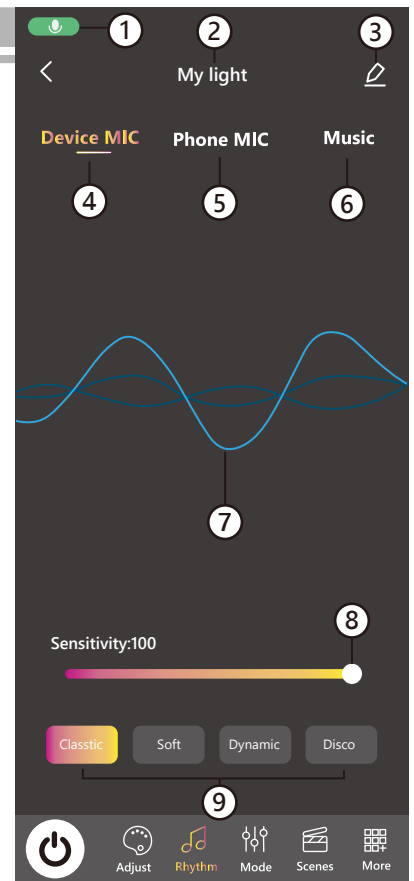

# RHYTHM MODE

## RHYTHM MODE-PHONE MIC

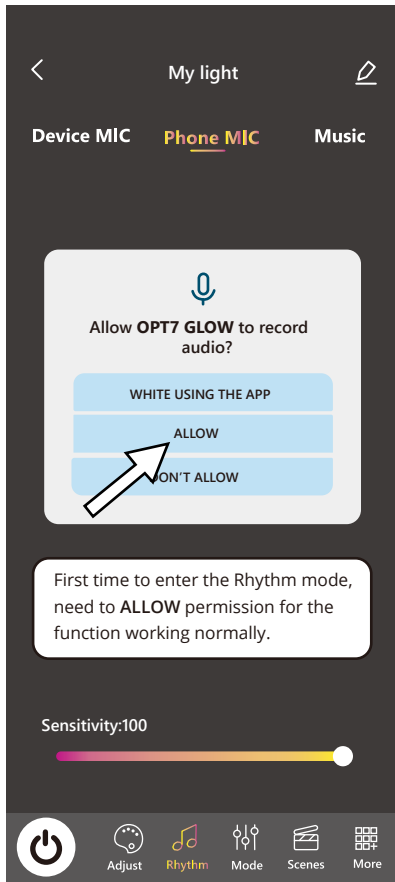

### INTRODUCTION

- 1: Cellphone MIC is receiving (Not all cellphone support)
- 2: Device name
- 3: Device setting
- 4: Device MIC (use the OPT7 light to receive)
- 5: Phone MIC (use the cellphone to receive)
- 6: Music MIC (use the cellphone music)
- 7: Sound wave (changes with the audio)
- 8: Radio sensitivity adjust

### IMPORTANT

- \*The Phone MIC supports Android Auto only
- \*When using the Phone MIC, users must enable the background permissions.
- \*Phone MIC supports only a device or a group at once.

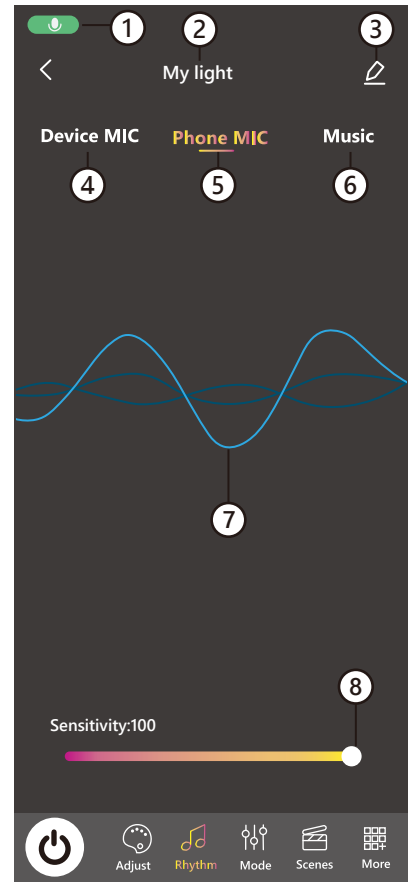

## RHYTHM MODE-MUSIC MIC

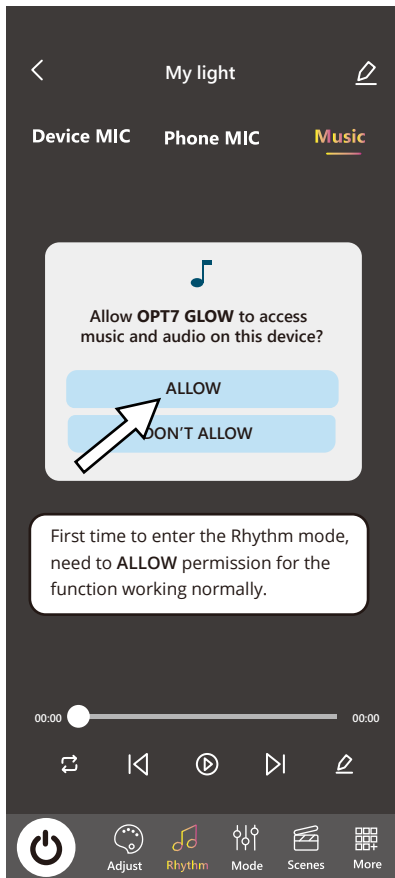

### INTRODUCTION

- 1: Playlist (9 built-in songs)
- 2: Media player
- 3: Edit the playlist

### HOW TO USE PHONE MUSIC

#### ANDROID

The music files on the phone will be imported into the playlist automatically.

#### IOS

Need to connect to iTunes on a computer to download the music file to the iPhone.

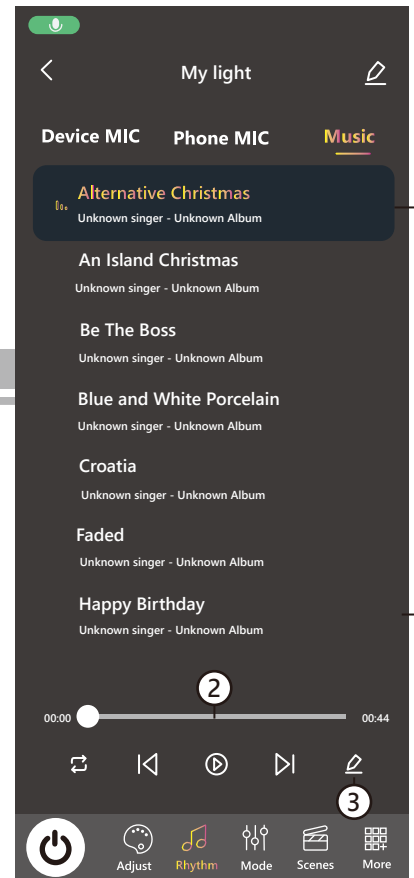



# RHYTHM MODE

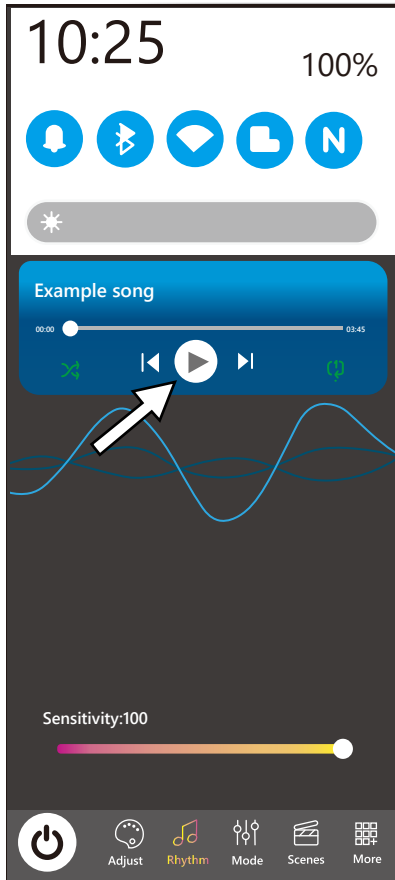

## ANDROID SYSTEM

### BACKGROUND PLAYING

The Phone MIC in the APP allows music to play in the background while users are using other Apps.

## ANDROID SYSTEM

### SPLIT SCREEN

The OPT7 GLOW supports the split screen function so keep both the music app and the OPT7 GLOW on the screen, the function will work.

### IMPORTANT

- \*The Phone MIC supports Android Auto only.
- \*When using the Phone MIC, users must enable the background permissions.
- \*Not all the cellphones support the split screen function.
- \*Music supports only a device or a group at once.

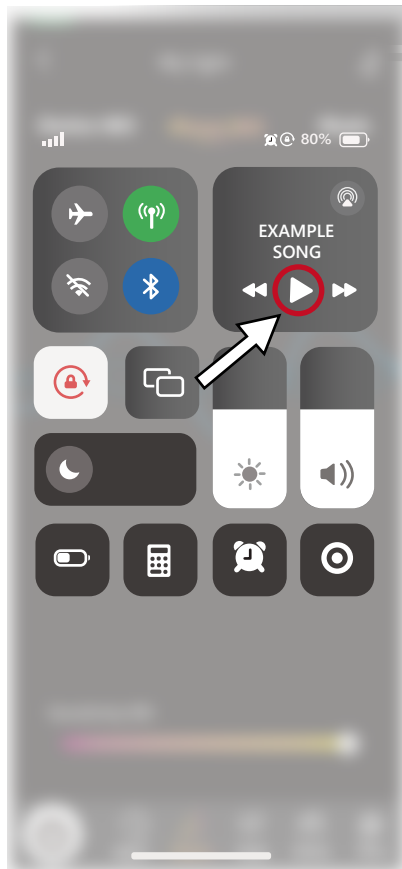
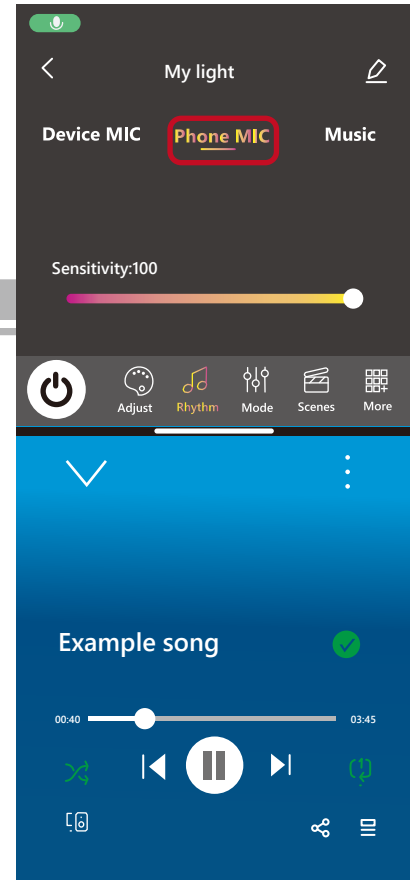

## IOS SYSTEM

### BACKGROUND PLAYING

The Phone MIC in the APP allows music to play in the background while users are using other Apps.

### IMPORTANT

- \*The Phone MIC does not support Apple CarPlay.
- \*When using the Phone MIC, users must enable the background permissions.

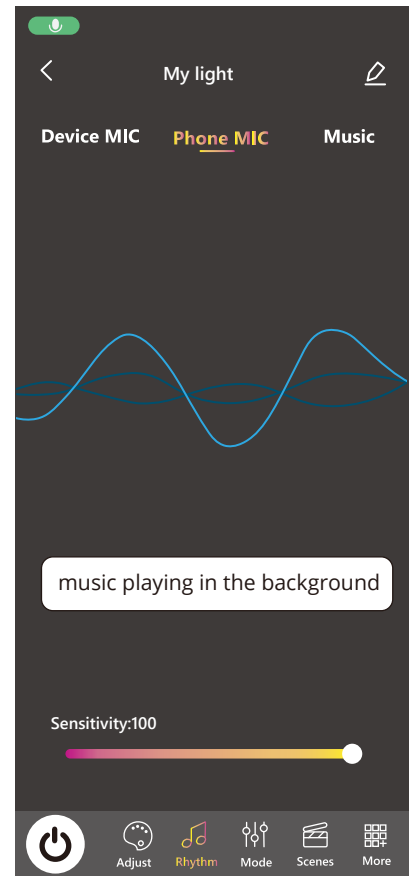

# LIGHT MODE

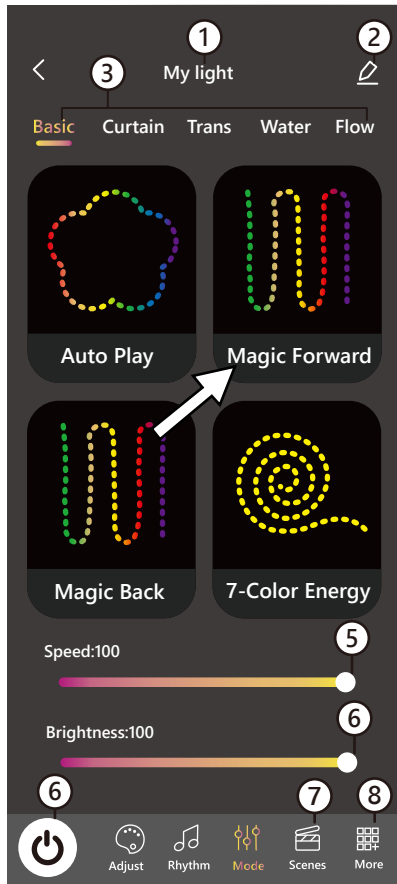

## LIGHT MODE

### INTRODUCTION

- 1: Device name
- 2: Device setting
- 3: Light mode catalog
- 4: Light mode with animation (touch one to set)
- 5: Speed adjust
- 6: On/Off
- 7: Scenes mode
- 8: More information

## SCENES MODE

### INTRODUCTION

- 1: Device name
- 2: Device setting
- 3: 4 scenes modes (touch to set the light mode not supposed to add one)
- 4: On/Off
- 5: More information

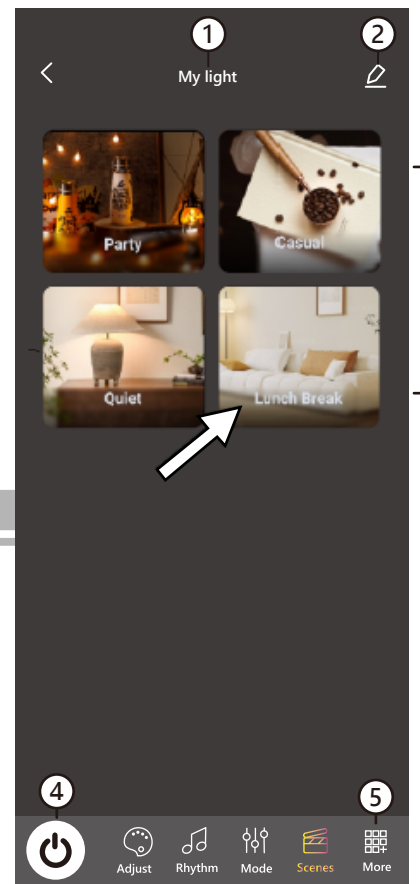

## MORE INFORMATION

### INTRODUCTION

#### 1: FAQ (KNOWLEDGE BASE)

Access our Knowledge Base for comprehensive guides and instructional videos to support your installation requirements effectively.

#### 2: OPT7 CUSTOMER SUPPORT

OPT7 offers comprehensive customer support, including assistance with your questions, technical issues, and app functionality.

#### 3: WARRANTY REGISTRATION

Learn how to file a warranty claim and register your product for warranty.

#### 4: SOCIAL MEDIA

Stay updated with OPT7 on social media for new tips, tricks, giveaways, and the latest information for auto enthusiasts.

#### 5: INSTALLATION GUIDES:

Explore our install guides for a seamless experience.

#### 6: VIDEO TUTORIAL

Subscribe to the OPT7 YouTube Channel for installation tutorials, product highlights, and more.

#### 7: USER TERMS

Learn about our privacy policy and find out what information we collect when placing an order.

#### 8: GOOGLE CLOUD TERMS OF SERVICE

